

---

# **PCS Hardware Manual**

**Release 2.1/1.1**

Embention Sistemas Inteligentes, S.A.

2026-04-23

# Contents

Basic Connection Diagram .....	9
First Steps.....	10
ON/OFF .....	10
Battery Charge.....	11
Warnings .....	12
Antennas .....	13
Main Features .....	15
Part list .....	15
Electrical Specifications.....	16
Mechanical Specifications.....	17
Dimensions .....	18
Interfaces .....	19
Connector Layout.....	19
Mating Connectors .....	19
Datalink Kits .....	22
Mechanical Installation .....	25
Pole Mount Installation .....	27
Expansion Bay Access.....	28
Antenna Integration .....	28
Electrical.....	29
Pinout.....	29
Main Connector pinout.....	29
Expansion Bay Connector pinout .....	36
Harnesses .....	39
Dimensions .....	40
Pinout.....	29
Veronte Harness Blue 68P .....	42
Veronte Control Stations: Conn Harness PCS 2.1.....	45
Ethernet Internal Device Connection.....	46
Connection .....	47
Software update configuration .....	48
Joystick Configuration.....	48
PWM Configuration .....	48

Advanced Wi-Fi Configuration.....	48
Tilt activation distance .....	50
Preventive Maintenance .....	51
Corrective Maintenance.....	51
Software update .....	52
Internal Radio Configuration.....	53
Adjustable Antenna Mount .....	53
Datalink Kit Installation and Configuration .....	57
Datalink Kit A/B/C - Veronte SDL Modem .....	57
Datalink Kit D - DTC Modem .....	60
Datalink Kit F/G - Silvus Modem.....	69
Hardware Installation .....	69
Silvus radio configuration.....	74
Silvus radio configuracion on PC .....	76
Silvus radio configuration in autopilot.....	77
Datalink Kit H/I - MicroHard Modem.....	77
Datalink Kit J/K - Amplified Veronte SDL Modem.....	83
Maintenance mode.....	90
Connection not established .....	90

# Scope of Changes

- Version 1.0
  - Added:
    - First version issued
- Version 1.1
  - Fixed:
    - Updated passwords in the [Software Installation](#) section

# Introduction

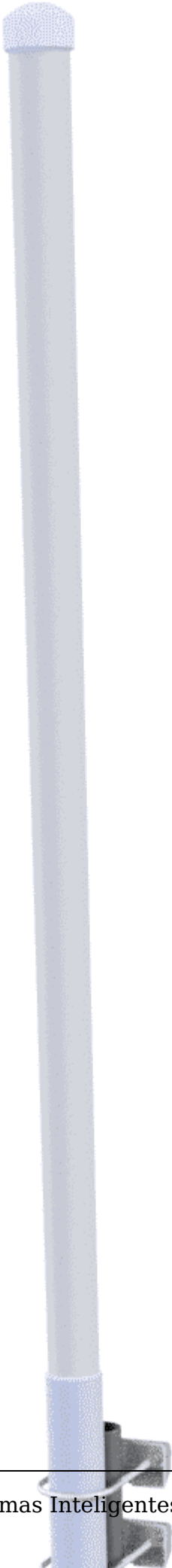

## Veronte PCS

**Veronte PCS** is a rugged control station hardware designed for outdoors use. The aluminium enclosure with IP54 protection allows the operation of the system in all weather conditions by protecting the electronics from rain and harsh environments.

The foldable mast included can be extended up to 3 m, rising the radio modules and antennas for maximizing the datalink LOS. Furthermore, the embedded **Veronte Autopilot 1x** includes all sensors needed for professional drone operations, enabling RTK, differential barometer, operations from moving vehicles, relative missions...

The whole system is delivered with a rugged plastic storage case for easy transportation.



### Rugged plastic case

**Veronte PCS** combines perfectly with **Veronte MCS** control stations. This setup allows installing the **Veronte PCS** unit (installing datalink and sensors) on open fields, maximizing the performance of GNSS receivers and datalinks, while operator can operate from a safe location.

**Veronte PCS** is ready to be used with a ground configuration, all sensors and devices integrated and the required wires to connect it to any other Veronte device (like **T28 Tracker** or **MCS**).

The main applications for **Veronte PCS** are:

- Mapping and photogrammetry.

- Surveillance.
- Environmental control and research.
- Firefighting.

# Quick Start

## Basic Connection Diagram

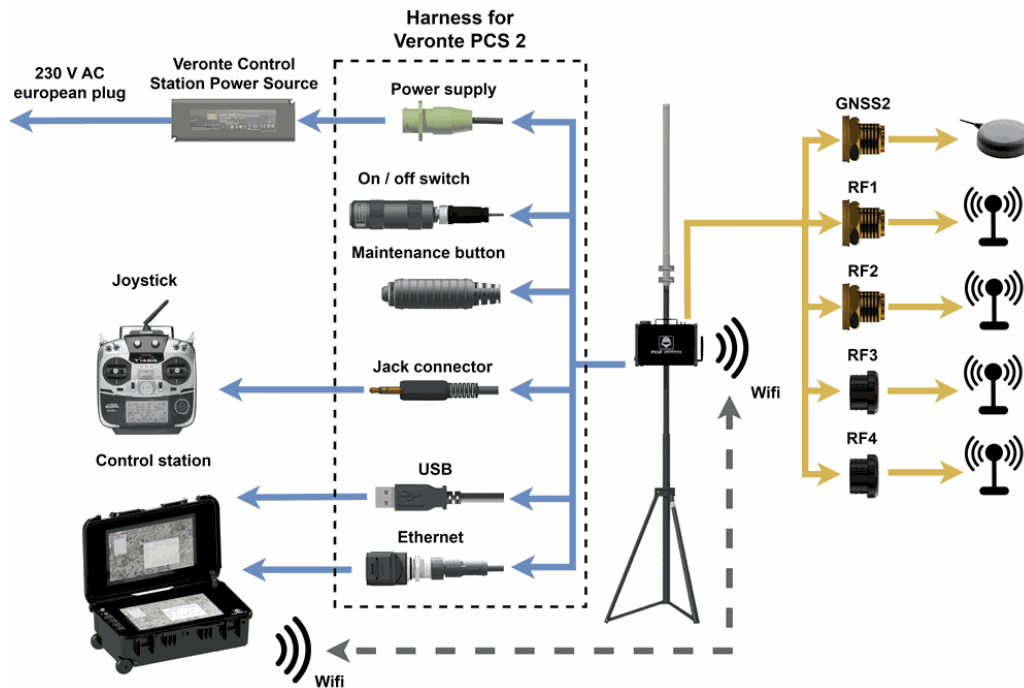

**SMA Connections table**

Radio modem	RF1	RF2	RF3	RF4	GNSS2
No modem	Internal Digi radio of Autopilot 1x	NC	NC	NC	Second antenna for GNSS
DTC		Channel A of modem output (amplified)	Channel B of modem output (not amplified)	NC	
Silvus		Channel A1 of	Channel A1 of	Channel A2 of	

<b>SMA Connections table</b>					
<b>Radio modem</b>	<b>RF1</b>	<b>RF2</b>	<b>RF3</b>	<b>RF4</b>	<b>GNSS2</b>
		modem output	modem output	modem output	
Microhard		Modem output (amplified)	NC	NC	
SDL04		Modem output (not amplified)	NC	NC	
SDL09 or SDL24		Modem output (amplified if amplifier module is used)	NC	NC	

## First Steps

### ON/OFF

To switch on and off the **PCS**, it is necessary to attach the **PCS Harness** and connect an antenna.

By pressing the button for 2 seconds, the light will turn on and shine blue.

To turn the device off, the push button shall be pressed for 2 seconds (until the blue light turns off). The push button delay is implemented to avoid unwished disconnections.

Once the **PCS** is on, the connector can be detached and the system will continue working.

### **Warning**

The connector only can be deattached in case of operating with battery and wireless. In this case the **PCS** will continue working, hence it will consume battery and the user has to remember to turn off the **PCS** after using it (plugging in the harness again).

### **Important**

In order to not stress the battery unnecessarily, do not forget to turn off the system after using it.

## Battery Charge

**Veronte PCS** can be connected and disconnected from the power supply during the operation without turning off the system. In case of external power supply disconnection, the smart battery management system will switch automatically from external power supply to the internal battery.

In order to have a redundant power supply during operation and ensure the robustness of the system, it is recommended to use always the external power supply so the internal battery will be used as back-up.

**PCS** is provided with an internal intelligent battery charger which improves the charging process and optimizes it. In order to charge the battery, follow the next steps:

1. Ensure the power source is properly connected.
2. The Battery status shall be checked in the provided software.

 **Note**

There is no need on turning on the system for charging the **PCS**. As soon as the power supply is connected, the battery starts charging.

 **Warning**

Do **NOT** charge with a different power supply. It will damage the system.

## Warnings

- Each pin of the **expansion bay connector** (the connector with 16 pins) has a current limit of **4 A**; except for pin 8 which has **2 A**. Higher intensities may damage internal components.
- Do not start a mission without a **charged battery**.
- Make sure the **distance between ground end and air end** is over 5 m.
- **Port RS-232 has possible connections** in both external harnesses (pin 19 is transmitter and pin 20 is receiver) and Expansion Bay (pin 14 is transmitter and pin 16 is receiver).

 **Caution**

Only one of both can be used. They drive to the same input channel, but this configuration is thought to ease the connection of any device from the expansion bay if needed.

- **Port RS-485** is used by default by the **Veronte Autopilot 1x** for **Ethernet connection**. Please contact us before using it for other purposes.
- Only one DHCP device connection can be done simultaneously. If more than one is meant to be connected, then it is needed to configure a Static IP.
- **Veronte PCS** is IP54 protected while closed. However, it **loses its water resistance** meanwhile the outer cover is open.
- **Do not break warranty seals**. Please contact us before doing it.
- **Do not cover the pressure purge** in order to ensure the correct flow of the system

- **Avoid shocks** during transportation or operation, some of the components could suffer damage.

**Note**

For safer operations, it is recommended to operate the Veronte PCS connected to an external power source, using the internal battery as back-up.

## Antennas

- Users **must not power on a PCS** without a suitable antenna or **50 Ω load** connected to the RF port.

**Danger**

This may damage the PCS unit.

- Guarantee that no obstacles will interrupt LOS communications.
- Keep the **PCS** in a position where the GPS antenna is facing to the open sky for better satellite view.
- Operators should not stand or walk in front of any high gain antenna such as dish antennas, nor should they allow anyone else to do so.
- Operators should not operate an RF transmitter or power amplifier with any of its cover removed, nor should they allow anyone else to do so.
- At 2.4 GHz, operators should keep the minimum distances of the following table:

Antenna			Minimum safe distance (m) for transmitter powers				
Type	Gain (dBi)	Gain Ratio	1 W	2 W	4 W	10 W	30 W
Omni	3	2	0.4	0.6	0.8	1.3	2.2
Sector	20	100	2.9	4	5.6	9	15.5

---

Antenna			Minimum safe distance (m) for transmitter powers				
Type	Gain (dBi)	Gain Ratio	1 W	2 W	4 W	10 W	30 W
Parabolic dish	35	3162	16	22.5	32	50	87

# Technical

## Main Features

- Ready for operation
- Compatible with Veronte MCS or third party computers
- RTK & differential barometer base
- Wifi, Ethernet and USB communications
- Expansion bay (free space for customer electronics installations)
- Easy maintenance
- 2 hours of battery life
- Battery over discharge protection

## Part list

The system consists of a multiple components listed below.

- **Veronte PCS** Control Station Unit.
- Pole and wall mounting accessories.
- Foldable mast.
- Connection harness.
- Veronte Control station power source (euro plug). This power supply is worldwide compatible if the power cable is changed.
- 5 m ethernet extension cable.
- 5 m USB A extension cable.
- 5 m joystick extension cable.
- Rugged transport case.
- Omnidirectional antenna - 2.4G Hz and 3.2d Bi.
- Datalink (not always, depending on variant).
- Amplifier (not always, depending on variant).
- Cable power extension connector - 5m - Amphenol 6P.

The **Veronte PCS** Control Station Unit is built with a **Veronte Autopilot 1x** inside to manage communications.

## Electrical Specifications

PCS DC input	14 to 24 VDC
PCS power	30 W to 80 W (depending on version)
Power supply AC input	180-264 VAC 50-60 Hz
Battery type	LiFePO4
Battery capacity	10 Ah
Battery operation time	2 hours typically (depending on version)
Wifi	2.4GHz and 5GHz configurable Wifi output
RF1 and RF2 Frequencies	400MHz, 900MHz or 2.4GHz (depending on version)
RF1 and RF2 Impedance	50 Ohm
GNSS 1	Integrated GNSS antenna. 40dB Gain, covering GPS/QZSS L1, GLONASS G1, Galileo E1, BeiDou B1, as well as SBAS
GNSS 2	

	SMA female connector for secondary GNSS antenna
Expansion bay I/O	RS-232, CAN and Ethernet. Each pin has a current limit of 4 A; except for pin 8 which has 2 A
External I/O	1x USB, 2x CAN ports, Ethernet, 16x PWM, PPM, 4x ADCs and 1x I2C
Expansion bay power outputs	3.3 V / 5 A, 5 V / 5 A, 12 V / 5 A and 24 V / 5 A

## Mechanical Specifications

PCS Weight	5.7 kg max
PCS + Pole Weight	10.2 kg max
Operating temperature	-20 to 60 °C
Environmental protection	IP54
Transport case	Rugged plastic case, quad track wheels, pressure purge valve,

side handles and carry handle

### Dimensions

Below you can find a measurements drawing for the PCS.

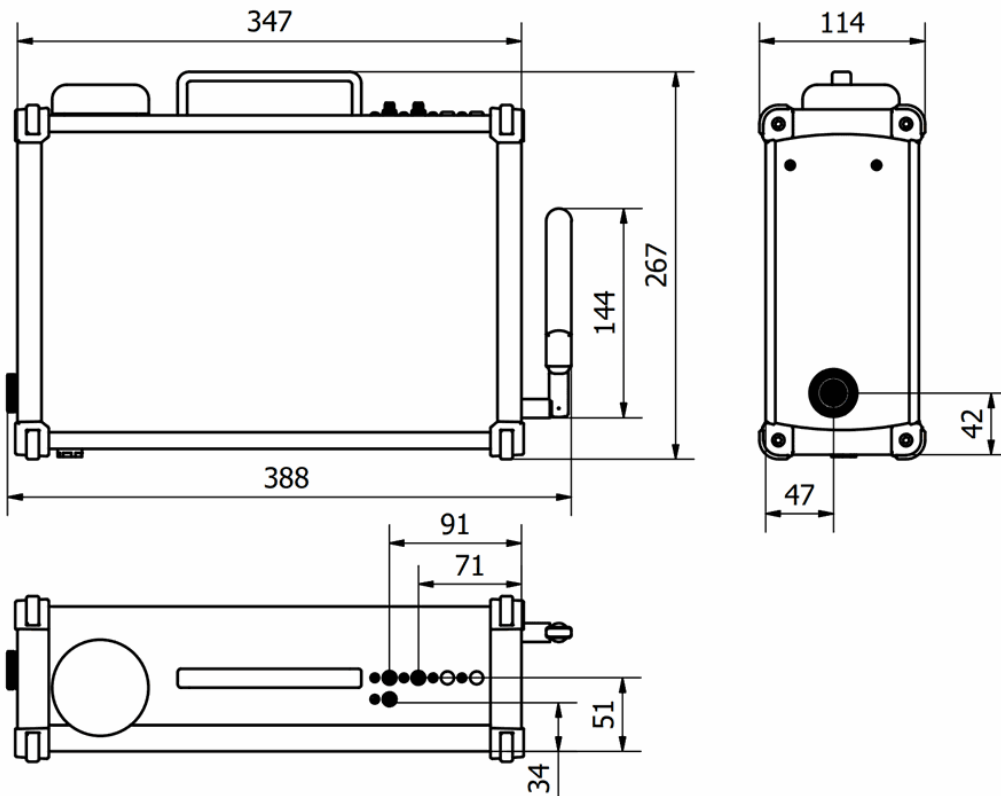

### PCS dimensions (mm)

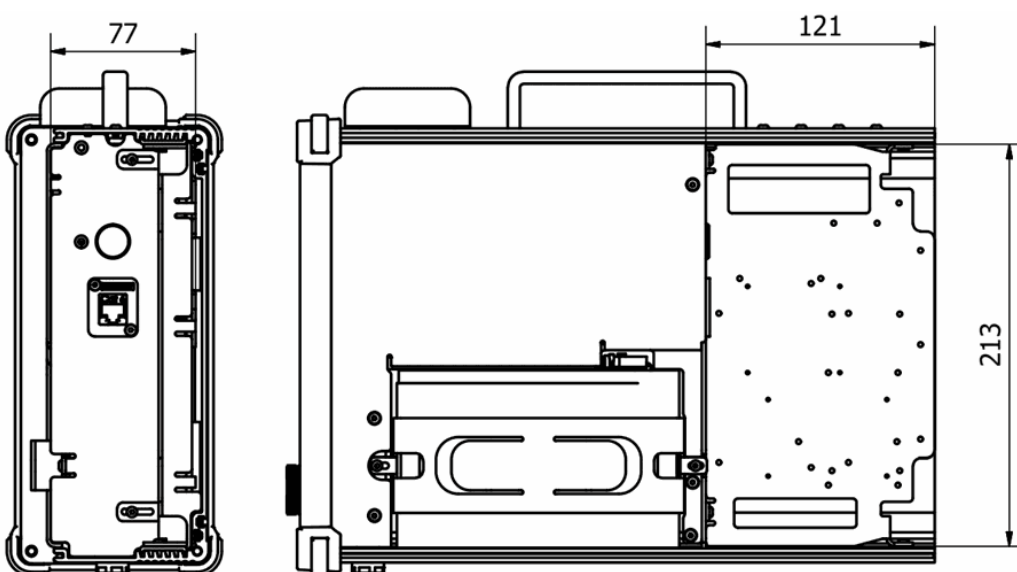

### PCS dimensions (mm) - Bay

**Veronte PCS** is supplied together with a telescopic foldable mast that can be extended up to 3 m. The maximum and the minimum dimensions of the system are shown below.

**PCS dimensions - Telescopic**

**PCS dimensions - Case**

## Interfaces

### Connector Layout

Index	Connector
1	Integrated GNSS antenna
2	SMA connectors, see <a href="#">SMA Connections table</a> to know what they are connected to
3	Wifi antenna connector (SMA female RP)
4	PCS Harness connector.
5	Automatic pressure purge
6	Connector for Expansion Bay
7	Ethernet connector

### Mating Connectors

Index	PCS Connector	Mating Connector
2	SMA connectors	SMA Male. Antennas depending on the



<b>Index</b>	<b>PCS Connector</b>	<b>Mating Connector</b>
	(SMA female RP)	Datalink Kit are detailed <a href="#">below</a>
3	Wifi antenna connector (SMA female RP)	SMA Male. Antenna (RUTX10000000) (Embention reference <b>P011834</b> )

Index	PCS Connector	Mating Connector
4	Main Connector HEW.LM.368.XLNP	<p>Mating connector: FGW.LM.368.XLCT (Embention reference <b>P005550</b>)</p> <p>Mating harnesses available on demand:</p> <ul style="list-style-type: none"> <li>• Veronte Control Stations: Conn Harness PCS 2.1 (Embention reference <b>P007696</b>)</li> <li>• Veronte Harness Blue 68P (Embention reference <b>P001114</b>)</li> </ul>
6	Expansion Bay Connector EGG.2B.316.CLL	Mating connector: Veronte Connector PCS 16P (FGG.2B.316.CLAD72Z) (Embention





Index	PCS Connector	Mating Connector
		reference <b>P008623)</b>
7	Ethernet connector RJ45	Standard RJ45 connector

## Datalink Kits

Embention offers different Datalink kits to add a radio modem to the **PCS**. They are available with different device configurations in order to fit all operational requirements from each application. Each Datalink Kit variant is described below. To know how to install and configure each radio, read [Datalink Kit Installation and Configuration](#) section of this manual.

Veronte Control Stations: PCS Datalink	Part number	Radio modem	Frequency	Amplifier	RF Power	Video	Ante datash
Kit A (SDL24 2.4GHz - 1W - TM/ TC) 1.0	P008019	Veronte SDL24	2.4 GHz	No	1 W	No	 <a href="#">HG</a> <a href="#">PR</a>
Kit B (SDL09 900MHz - 1W - TM/ TC) 1.0	P008021	Veronte SDL09	900 MHz	No	1 W	No	 <a href="#">F</a>

<b>Veronte Control Stations: PCS Datalink</b>	<b>Part number</b>	<b>Radio modem</b>	<b>Frequency</b>	<b>Amplifier</b>	<b>RF Power</b>	<b>Video</b>	<b>Ante datasl</b>
Kit C (SDL04 400MHz - 1W - TM/TC) 1.0	P008023	Veronte SDL04	400 MHz	No	2 W	No	 <a href="#">BC</a>
Kit D (DT 2.4GHz - 5W - Video & TM/TC) 1.0	P008015	DTCRA	2.4 GHz	Yes	5 W	Yes	 <a href="#">HG2407</a> <a href="#">HG2415</a>
Kit F (SV 2.4GHz - 4W - Video + TM/TC) 1.0	P008017	Silvus	2.4 GHz	No	4 W	Yes	 <a href="#">FG</a>
Kit G (SV 2.4Ghz (4W) & 5.8GHz (2W) - Video + TM/TC) 1.0	P008018	Silvus	2.4/5.8 GHz	No	4/2 W	Yes	 <a href="#">HGV-245</a>
	P008020	MH2RA	2.4 GHz	Yes	5 W	Yes	

<b>Veronte Control Stations: PCS Datalink</b>	<b>Part number</b>	<b>Radio modem</b>	<b>Frequency</b>	<b>Amplifier</b>	<b>RF Power</b>	<b>Video</b>	<b>Ante datasl</b>
Kit H (MH 2.4GHz - 5W - Video & TM/TC) 1.0							 <a href="#">HG</a> <a href="#">PR</a>
Kit I (MH 900MHz - 10W - Video & TM/TC) 1.0	P008022	MH9RA	900 MHz	Yes	10 W	Yes	 <a href="#">HG</a> <a href="#">PR</a>
Kit J (SDL24 2.4GHz - 10W - TM/TC) 1.0	P009402	Veronte SDL24	2.4 GHz	Yes	10 W	No	 <a href="#">HG</a> <a href="#">PR</a>
Kit K (SDL09 900MHz - 10W - TM/TC) 1.0	P009403	Veronte SDL09	900 MHz	Yes	10 W	No	 <a href="#">F</a>

# Hardware Installation

## Mechanical Installation

 **Warning**

Do not forget to connect RF antenna before powering up.

There are 2 separate accessories for the Veronte PCS in order to mount the unit on a mast, on the Veronte Tracker or a wall.

The accessories are :

- **Pole Mount:**



- **Wall Mount:**

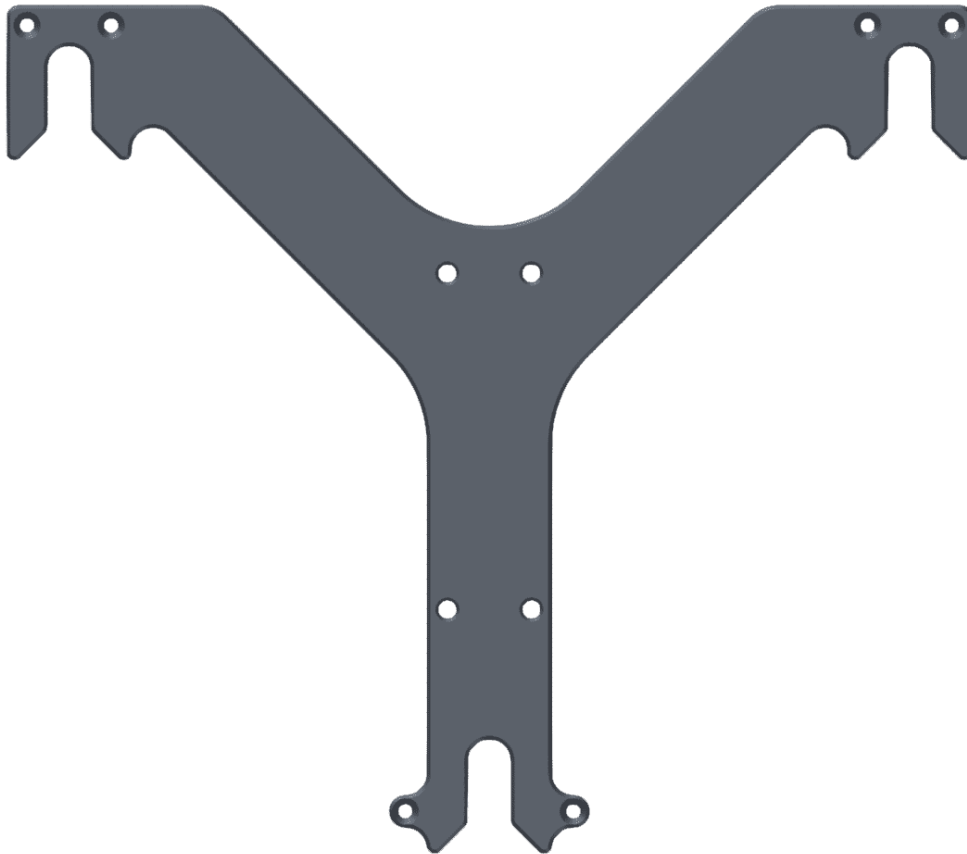

## Pole Mount Installation

The pole mount is composed by two aluminum brackets to assemble the PCS to the foldable mast.

To assemble the system follow the next steps:

1. Attach the wall mount to the PCS Control Station with M3 allen screw driver.

### **Pole Mount Installation - Step 1**

2. Screw the pole mount against the wall mount with M5 allen screw driver.

### **Pole Mount Installation - Step 2**

3. Introduce the pole through the pole mount.

### **Pole Mount Installation - Step 3**

4. Attach the ball chain to the pole mount with an M5 allen screw.

### **Pole Mount Installation - Step 4**

5. Screw the wing knob against the pole mount to fix the pole.

## Pole Mount Installation - Step 5

### Expansion Bay Access

This section explains how to access to the bay and adjust its position inside the **PCS**.

1. Remove the four M5 allen screws and the lateral plate of the wifi antenna side.

#### Expansion Bay Access - Step 1

2. Slide the frontal plate with Veronte logo.

#### Expansion Bay Access - Step 2

At this point, the expansion bay is accesible.

#### Expansion Bay Access - Step 2

3. Unscrew slightly the four M3 allen screws to slide up or down the expansion bay.

#### Expansion Bay Access - Step 3

4. Unscrew them completely to take out the bay plate.

#### Expansion Bay Access - Step 4

## Antenna Integration

The system uses different kinds of antenna to operate, they must be installed on the airframe. Here you can find some advice for obtaining the best performance and for avoiding antenna interferences.

### Recommended specifications for GNSS antennas

Specifications	Range
Antenna frequency L1	1561.098 MHz to 1602 MHz
Antenna frequency L2	1207.14 MHz to 1246 MHz

Specifications	Range
Amplifier gain	17 dB to 35 dB
Out-of-band rejection	<p>40 dB</p> <p><b>Note</b> Higher values are preferable. 30dB is considered the minimum acceptable value.</p>
Polarization	RHCP (Right-Hand Circular Polarization)
Minimum supply voltage	2.7 V to 3.3 V
Maximum supply current	50 mA

## Electrical

### Pinout

#### Main Connector pinout

The 68 pin main connector has the distribution of input/output channels as follows:

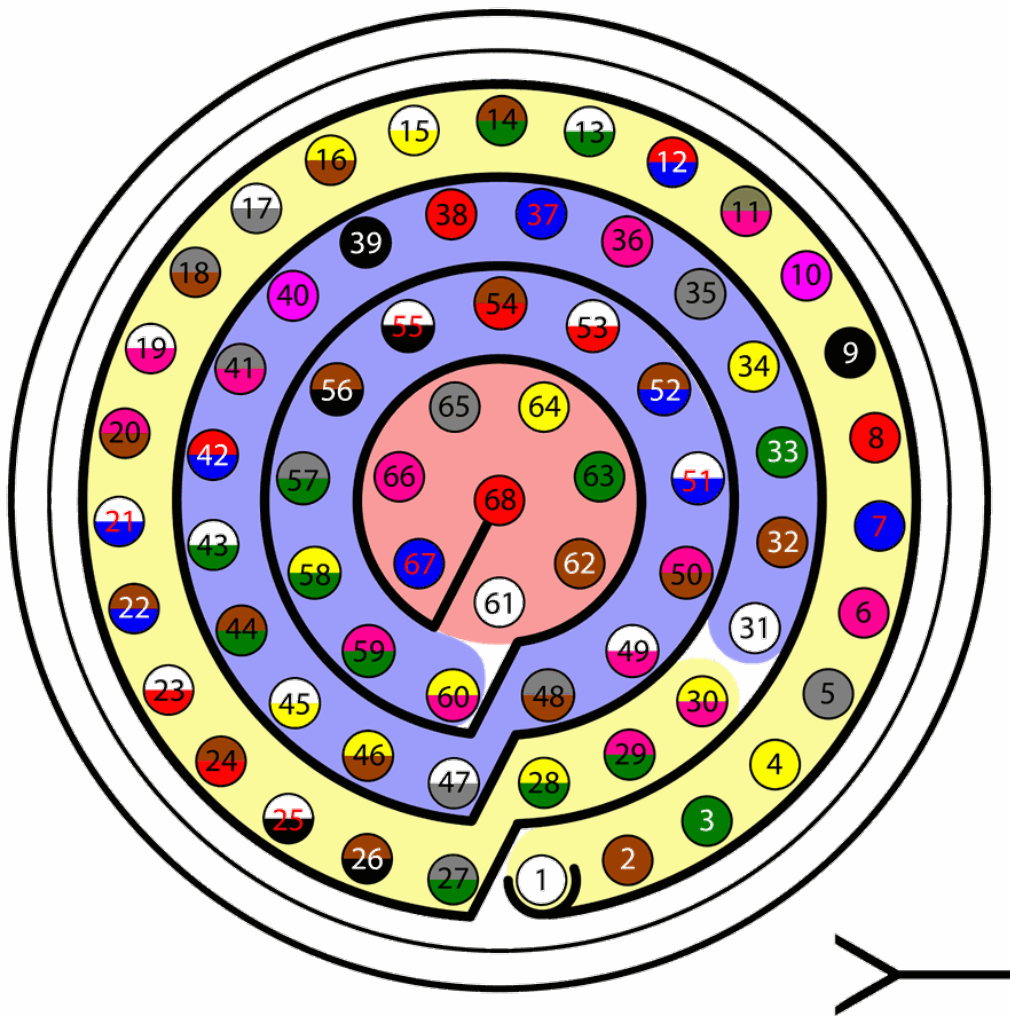

**PCS Harness Connector - HEW.LM.368.XLNP**

**Warning**

Check the pin number before connecting. The color code is repeated 3 times due to the amount of pins. First section (yellow) corresponds to pins 1-30, the second section (blue) to pins 31-60 and the third one (red) to pins 61-68. Pin number increases counterclockwise following the black line of the picture above.

PIN	Signal	Type	Description
1	I/O1	I/O	PWM / Digital I/O signal (0-3.3V). Protected against ESD and short circuit. Maximum current: 1.65 mA
2	I/O2	I/O	

<b>PIN</b>	<b>Signal</b>	<b>Type</b>	<b>Description</b>	
3	I/O3	I/O		
4	I/O4	I/O		
5	I/O5	I/O		
6	I/O6	I/O		
7	I/O7	I/O		
8	I/O8	I/O		
9	GND	GROUND		Ground signal for actuators 1-8
10	I/O9	I/O		PWM / Digital I/O signal (0-3.3V). Protected against ESD and short circuit. Maximum current: 1.65 mA
11	I/O10	I/O		
12	I/O11	I/O		
13	I/O12	I/O		
14	I/O13	I/O		
15	I/O14	I/O		
16	I/O15	I/O		
17	I/O16	I/O	Ground signal for actuators 9-16	
18	GND	GROUND		
19	RS 232 TX	Output	RS 232 Output (-13.2V to 13.2V Max, -5.4V to 5.4V)	

<b>PIN</b>	<b>Signal</b>	<b>Type</b>	<b>Description</b>
			Typical). Protected against ESD and short circuit
20	RS 232 RX	Input	RS 232 Input (-25V to 25V Max, -0.6V Low and 2.4V High Threshold). Protected against ESD and short circuit
21(*)	Tx+	Output	Ethernet transmitter positive
22	Analog 4	Input Analog	Input 0-3.3V. Protected against ESD and short circuit
23(*)	No connect	Input Analog	Input 0-3.3V. Protected against ESD and short circuit
24(*)	Tx-	Output	Ethernet transmitter negative
25	CANA_P	I/O	CANbus interface, up to 1Mbps (2.3V Typical, 1.2V-2.3V Differential). Protected against ESD
26	CANA_N	I/O	Twisted pair with a 120 ohms Zo recommended (2.3V Typical, 1.2V-2.3V Differential). Protected against ESD
27(*)	24V	Output	Power supply. Common with pin 44
28	CANB_P	I/O	

<b>PIN</b>	<b>Signal</b>	<b>Type</b>	<b>Description</b>
			CANbus interface. It supports data rates up to 1 Mbps. Protected against ESD
29	CANB_N	I/O	Twisted pair with a 120 ohms Zo recommended. Protected against ESD
30(*)	Rx+	Input	Ethernet receiver positive
31	I2C_CLK	Output	Clk line for I2C bus (0.3V to 3.3V). Protected against ESD and short circuit
32	I2C_DATA	I/O	Data line for I2C bus (0.3V to 3.3V). Protected against ESD and short circuit
33	GND	GROUND	Ground for 3.3V power supply
34	3.3V	POWER	3.3V - 100mA power supply. Protected against ESD short circuit with 100mA resettable fuse
35	GND	GROUND	Ground for 5V power supply
36	5V	POWER	5V - 100mA power supply. Protected against ESD short circuit with 100mA resettable fuse
37	GND	GROUND	Ground for analog signals

<b>PIN</b>	<b>Signal</b>	<b>Type</b>	<b>Description</b>
38	ANALOG_1	Input	Analog input 0-3.3V. Protected against ESD and short circuit
39	ANALOG_2	Input	Analog input 0-3.3V. Protected against ESD and short circuit
40	ANALOG_3	Input	Analog input 0-3.3V. Protected against ESD and short circuit
41(*)	RX-	I/O	Ethernet receiver negative
42	FTS1_OUT	Output	Deadman signal from comicro. Protected against ESD and short circuit
43	FTS2_OUT	Output	!SystemOK Bit. Protected against ESD and short circuit
44(*)	24V	Output	Power supply. Common with pin 27
45	UARTA_TX	Output	Microcontroller UART
46	UARTA_RX	Input	Microcontroller UART
47	GND	GROUND	Ground signal comicro power supply
48(*)	VCC	POWER	Power supply (14 to 24V). Protected against reverse polarity

PIN	Signal	Type	Description
49(*)	GND	GND	Ground
50(*)	OUT_RS485_P	Output	<p><b>Warning</b></p> <p>RS-485 bus is used by default by the autopilot for ethernet communications (and consequently wifi). Do not connect these pins unless it is asked to <a href="mailto:support@embention.com">support@embention.com</a>.</p>
51(*)	OUT_RS485_N	Output	
52(*)	IN_RS485_N	Input	
53(*)	IN_RS485_P	Input	
54(*)	RS-485_GND	GND	
55(*)	No connect	/	/
56(*)			
57	EQEP_S	I/O	DIGITAL output / DIGITAL input / Encoder strobe input (0-3.3V). Protected against ESD and short circuit
58	EQEP_I	I/O	DIGITAL output / DIGITAL input / Encoder index input A (0-3.3V). Protected against ESD and short circuit
59	GND	GROUND	Ground for encoders
60	V_USB_DP	I/O	Veronte USB data line. Protected against ESD
61	V_USB_DN	I/O	Veronte USB data line. Protected against ESD

PIN	Signal	Type	Description
62	USB_GND (GND)	GROUND	USB ground
63(*)	No connect	/	/
64(*)			
65	GND	GROUND	Veronte ground input
66	GND	GROUND	Veronte ground input
67	VCC	POWER	Power supply (14V to 24V). Protected against reverse polarity
68	VCC	POWER	

 **Note**

The functions marked with (\*) differ from Veronte Autopilot 1x Pinout

 **Warning**

- All GND pins are common.
- Pins 27, 67 and 68 are common. Connect them to the same power supply voltage.
- CANA and CANB buses do not have termination resistor enabled, user should add them based on its own wiring design. However, users should also be aware that depending on the 1x unit inside the PCS, this resistance may or may not be enabled by default.

Expansion Bay Connector pinout

### Expansion Bay Connector

<b>PIN</b>	<b>Signal</b>	<b>Type</b>	<b>Description</b>
1	3.3 V	Output	Output power supply. Maximum current: 4 A.
2	GND	GROUND	Ground. Maximum current: 4 A.
3	5 V	Output	Output power supply. Maximum current: 4 A.
4	GND	GROUND	Ground. Maximum current: 4 A.
5	12 V	Output	Output power supply. Maximum current: 4 A.
6	GND	GROUND	Ground. Maximum current: 4 A.
7	24 V	Output	Output power supply. Maximum current: 4 A.
8	GND	GROUND	Ground. Maximum current: 2 A.



PIN	Signal	Type	Description
			<p><b>Warning</b> This pin has a different maximum current.</p>
9	No connect	/	/
10			
11			
12	PPM	Input	Pin for PPM signal (EQEP_A).
13	CANA_P	I/O	CANbus interface, up to 1Mbps (2.3V Typical, 1.2V-2.3V Differential).
14	RS 232-TX	Output	<p>RS 232 Output (-13.2V to 13.2V Max, -5.4V to 5.4V Typical).</p> <p><b>Warning</b> This pin is common with the</p>

PIN	Signal	Type	Description
			external pinout.
15	CANA_N	I/O	Twisted pair with a 120 ohms Zo recommended (2.3V Typical, 1.2V-2.3V Differential).
16	RS 232-RX	Input	RS 232 Input (-25V to 25V Max, -0.6V Low and 2.4V High Threshold). <b>Warning</b> This pin is common with the external pinout.

## Harnesses

A wire harness is a structured assembly of cables and connectors used to organize and manage wiring in electrical and electronic systems. It is designed to ensure a tidy and secure installation of cables, preventing tangles, electromagnetic interference, and facilitating maintenance.

**Veronte PCS 2.1** has two compatible harnesses:

<p><b>Veronte Harness Blue 68P</b></p>	<p><b>Veronte Control Stations: Conn Harness PCS 2.1</b></p>
	
<p>Harness available on demand with the Embention reference <b>P001114</b></p>	<p>Harness available on demand with the Embention reference <b>P007696</b></p>

Dimensions

- **Harness Blue 68P wire gauge:** 22 AWG
- **Cables lenght:** 52 cm
- **Harness plug dimensions:**

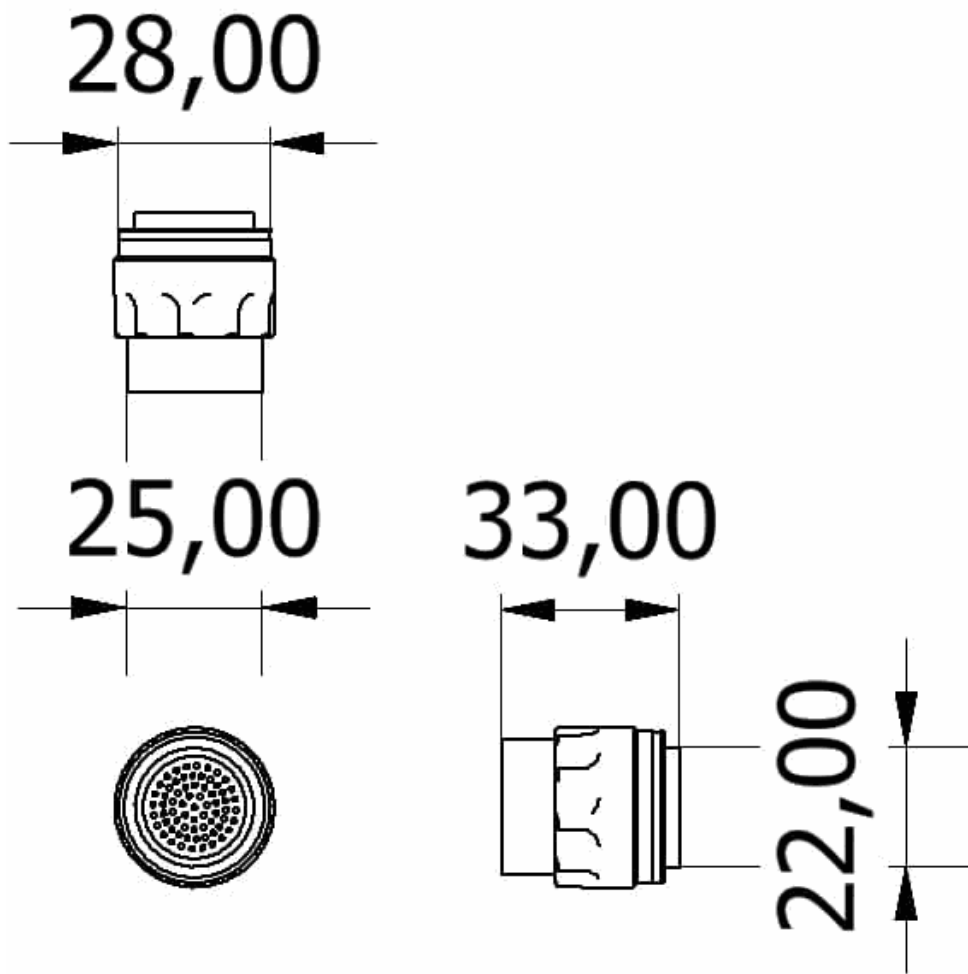

**Connector FGW.LM.368.XLCT dimensions (cm)**

Pinout

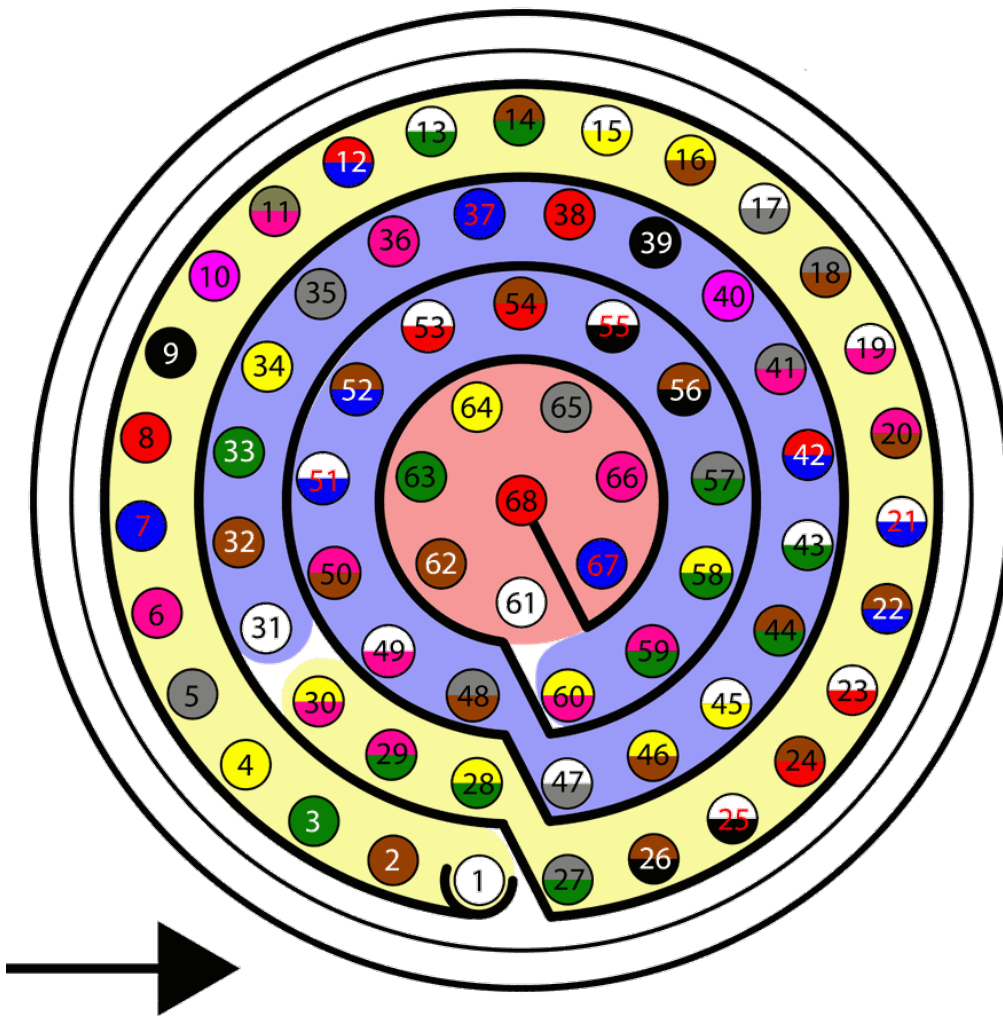

**Harness plug - FGW.LM.368.XLCT**

Veronte Harness Blue 68P

The pinout of the Veronte Harness **Blue** 68P is the same as the [Main Connector pinout](#) above. The **color code** of the harness wires is given below.

**Warning**

Check the pin number before connecting. The colour code is repeated 3 times due to the amount of pins. First section (yellow) corresponds to pins 1-30, the second section (blue) to pins 31-60 and the third one (red) to pins 61-68. Pin number increases following the black line of the pictures above: counterclockwise for the connector and clockwise for the plug.

---

<b>PIN</b>	<b>Color Code</b>	<b>PIN</b>	<b>Color Code</b>
1	White	35	Gray
2	Brown	36	Pink
3	Green	37	Blue
4	Yellow	38	Red
5	Gray	39	Black
6	Pink	40	Violet
7	Blue	41	Gray - Pink
8	Red	42	Red - Blue
9	Black	43	White - Green
10	Violet	44	Brown - Green
11	Gray - Pink	45	White - Yellow
12	Red - Blue	46	Yellow - Brown
13	White - Green	47	White - Gray
14	Brown - Green	48	Gray - Brown
15	White - Yellow	49	White - Pink

<b>PIN</b>	<b>Color Code</b>	<b>PIN</b>	<b>Color Code</b>
16	Yellow - Brown	50	Pink - Brown
17	White - Gray	51	White - Blue
18	Gray - Brown	52	Brown - Blue
19	White - Pink	53	White - Red
20	Pink - Brown	54	Brown - Red
21	White - Blue	55	White - Black
22	Brown - Blue	56	Brown - Black
23	White - Red	57	Gray - Green
24	Brown - Red	58	Yellow - Green
25	White - Black	59	Pink - Green
26	Brown - Black	60	Yellow - Pink
27	Gray - Green	61	White
28	Yellow - Green	62	Brown
29	Pink - Green	63	Green

<b>PIN</b>	<b>Color Code</b>	<b>PIN</b>	<b>Color Code</b>
30	Yellow - Pink	64	Yellow
31	White	65	Gray
32	Brown	66	Pink
33	Green	67	Blue
34	Yellow	68	Red

### Veronte Control Stations: Conn Harness PCS 2.1

The pinout of this harness is the same as the [Main Connector pinout](#) above. In addition, this harness has some connectors already implemented for easy operation. Below is detailed information on which pins these connectors are connected to:

<b>Connector</b>	<b>PIN</b>	<b>Signal</b>
<b>Power</b>	48	VCC
	47	GND
	65	GND
	66	GND
	67	VCC
	68	VCC
<b>ON/OFF Button</b>	23	5V
	49	GND
	55	BAT

Connector	PIN	Signal
	56	SYS_ON_CN
<b>Maintenance Button</b>	31	I2C_CLK
	32	I2C_DATA
<b>Jack Connector</b>	18	GND
	57	EQEP_S
<b>USB Type A</b>	60	V_USB_DP
	61	V_USB_DN
	62	USB_GND
<b>Ethernet Connector</b>	21	TX+ ETH
	24	TX- ETH
	30	RX+ ETH
	41	RX- ETH

 **Warning**

Do **NOT** connect the CS harness provided for other Veronte units. **ONLY** use PCS own Mating connector.

### Ethernet Internal Device Connection

PCS bay has an Ethernet connection fully isolated from the external connector. It is normally used for interconnection with video RF links. It can be used for any other device to integrate into the **PCS**.

# Software Installation

## Connection

**Veronte PCS** is a pre-configured device. It is built with an **Autopilot 1x** (hardware version 4.8) inside to manage communications, so configuration is done through the **1x**. Nonetheless, **MicroHard** and **DTC** datalinks are configured directly with a computer via ethernet.

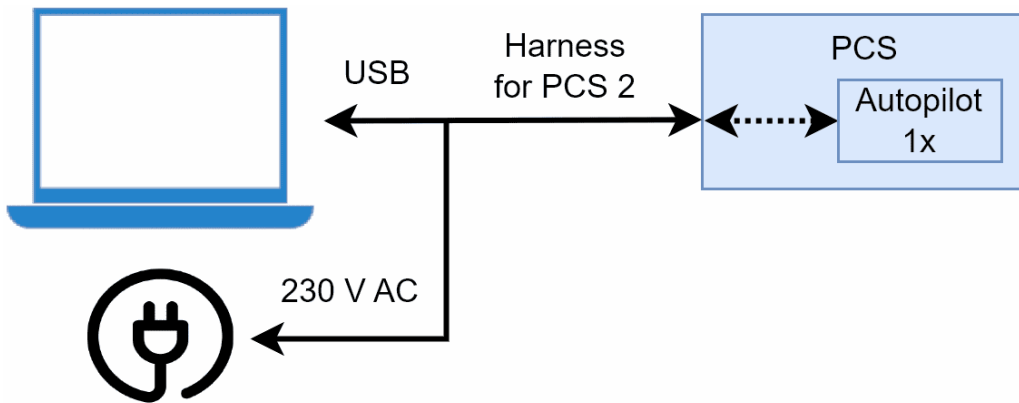

**USB connection**

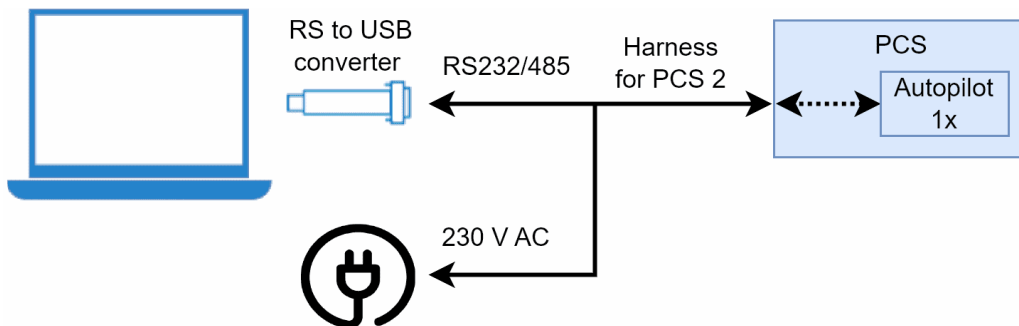

**Serial connection**

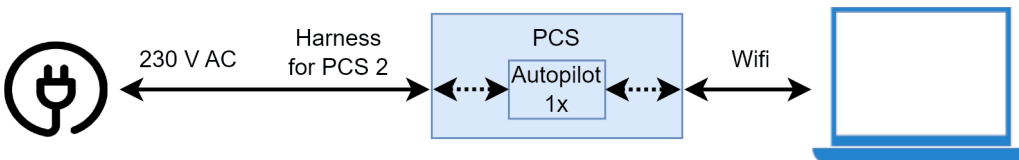

**Wifi connection**

To install the required software and configure **Veronte Autopilot 1x**, read the [1x Software Manual](#).

---

## Software update configuration

To update the **Autopilot 1x** software inside **Veronte PCS**, a specific connection must be made. To find out how to proceed, please refer to the [PCS - Operation](#) section of the **Veronte Updater** user manual.

## Joystick Configuration

Joystick connection is preconfigured on the main external connector (Pin 57 EQEP\_S) with **1x PDI Builder**. Wireless joystick connection is also possible with the installation of a joystick receiver on the Expansion Bay.

For more information, visit [Stick](#) section of **1x PDI Builder** user manual.

## PWM Configuration

PWMs 1 and 2 are pre-configured for a tracker antenna. This does not disable them for different applications (with a proper configuration).

To configure PWM signals for different applications, visit [PWM - Connections](#) section of the **1x PDI Builder** user manual.

## Advanced Wi-Fi Configuration

1. Connect the computer to the ethernet cable.
2. Open a browser and introduce the following address on the search bar:  
`192.168.8.1`.
3. The user name is `admin` and the password is one of the following:  
`EmbentionPCS20`, `EmbentionPCS21`, `#EmbentionPCS21`. For being able to Access this menu, the unit has to be linked.
4. Go to **SETUP WIZARD** ⇒ **STEP 3 - WIFI**. Here it is possible to configure the wifi password and activate/deactivate antennas.

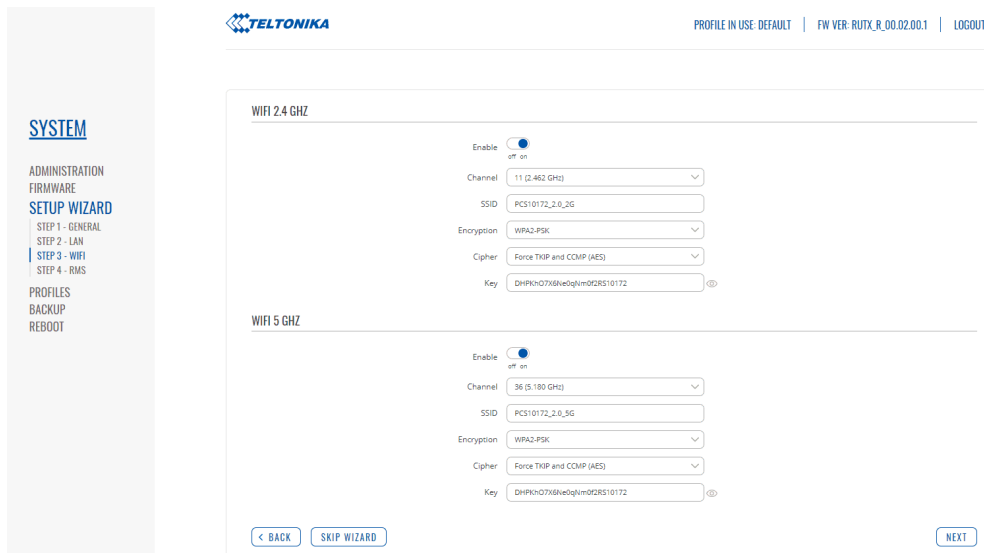

**WiFi menu**

**Important**

- The wifi SSID is: "PCS" + \- The wifi password is: "DHPKhO7X6Ne0qNm0f2RS" + \- The IP port can be configured by following the [Teltonika router manual](#), where the username and password to access the advanced configuration menu are specified in **step 3**.

**Warning**

Be careful when changing the login credentials on the router, because if they are lost, the router can only be accessed again by resetting it to the default configuration. If this happens, users should contact support team by creating a [Ticket](#) in their **Joint Collaboration Framework**.

---

## Tilt activation distance

In case of using a [Veronte T28](#), the threshold range (named as Tilt activation distance) can be changed with Veronte Ops, in the variable `Tilt Activation distance`.

To know how to change any variable in Veronte Ops, read [Inputs - Workspace](#) section of **Veronte Ops** user manual.

### **Note**

When the aircraft passes the long range threshold, **PCS** enables the tilt movement, the second directional antenna and disables the omnidirectional antenna.

# Maintenance

After installation, maintenance must be performed according to the present manual.

To facilitate this work whereby are described the procedures and methods. The maintenance manual of the **PCS** Control Station is divided in two parts: preventive and corrective maintenance.

## Preventive Maintenance

Preventive maintenance is required to ensure the optimal working state for the platform.

### **Post-flight**

1. Switch off the system by pressing the button for 2 seconds (until the blue light turns off).
2. Check all connectors, in case of abnormality or damage, please contact us for replacement: [support@embention.com](mailto:support@embention.com).
3. Attach all protection cups to all connectors in order to protect from dust.
4. Store the system in the supplied rugged case.
5. It is a good praxis to clean all connectors with a good contact cleaner after working in adverse conditions.

## Corrective Maintenance

### **Battery**

To extract the battery please follow the next steps:

1. Remove the four M5 allen screws and the lateral plate of the wifi antenna side.
2. Slide the frontal plate with Veronte logo.
3. Unscrew bot M3 allen screws of the battery.
4. Take out the battery pulling from both marked handles

5. Remove the battery. Moving the battery will take out the four battery supports, since they are not fixed. Use them again with the new battery.
6. Now the new battery can be placed and connected. Please take care with the polarity. The positive cable is marked with red.
7. To close the device do the same steps in the reverse way. Use **Loctite 243** to fix all screws and apply a 1 Nm of torque.

## Software update

To update the software, an additional app is required: [Veronte Updater](#).

### **Note**

The file with the new software version will be shared with the customer in the **Joint Collaboration Framework** when it is requested.

For more information about the **Joint Collaboration Framework**, read its [user manual](#).

# Integration examples

## Internal Radio Configuration

To configure the internal radio of the autopilot, read [Digi internal radio - Integration examples](#) section of **1x PDI Builder** user manual.

## Adjustable Antenna Mount



## Adjustable antenna mount

The **adjustable antenna mount** allows to set up certain antennas at 0, 45 or 90°, depending on the polarization desired.



**PCS antennas at 0, 45 and 90°**

To attach the an antenna to the holder with the **adjustable mount** read the following steps:

1. Slide the antenna through the slot.

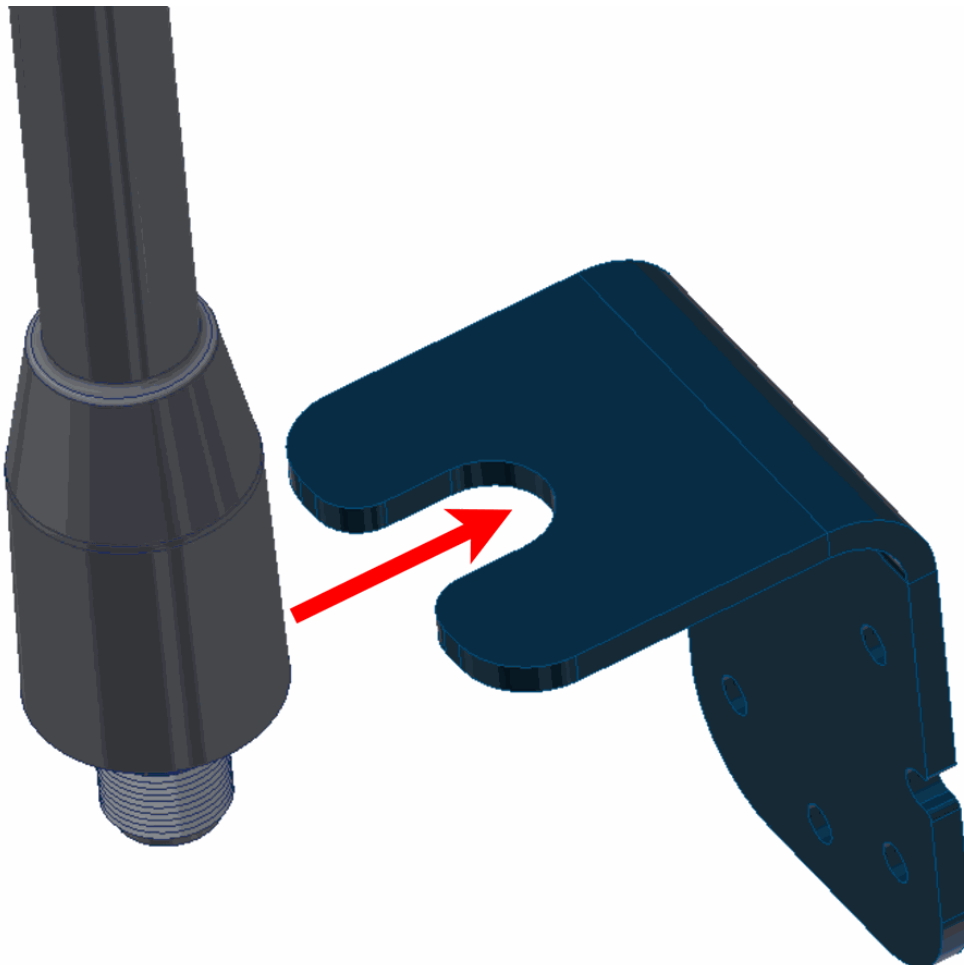

**Adjustable mount - Step 1**

2. Screw the connector and the nut to fix the antenna.

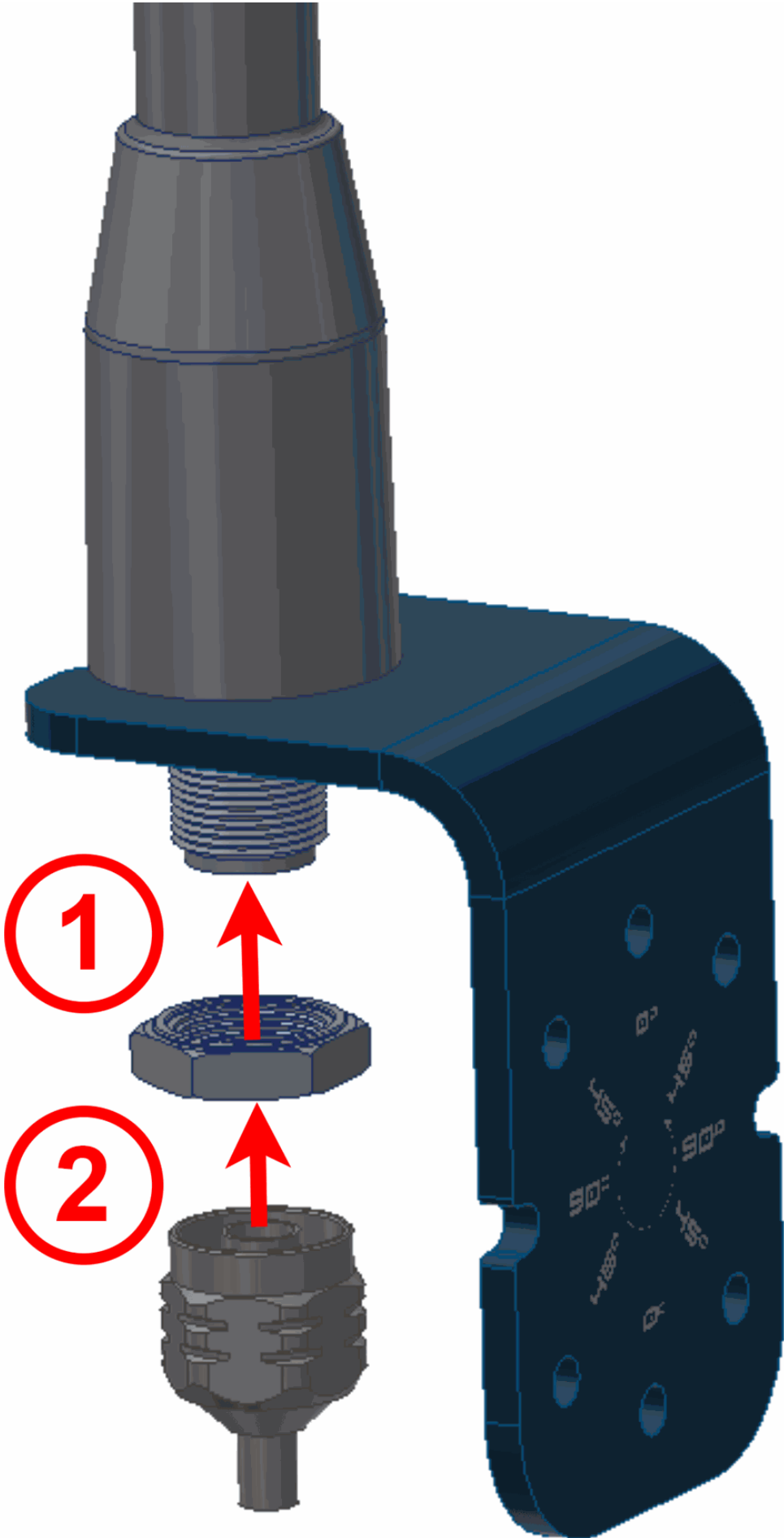

### Adjustable mount - Step 2

3. Attach the **adjustable antenna mount** with both knobs. Use the holes which correspond to the desired position.

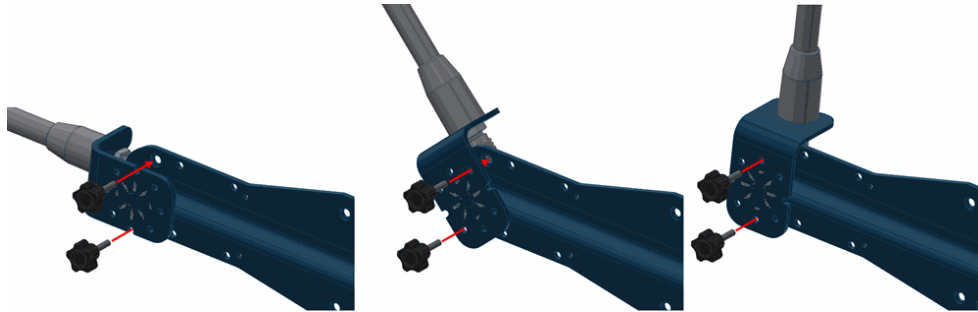

### Adjustable mount - Step 3

## Datalink Kit Installation and Configuration

To install a radio module in the **PCS**, follow the installation instructions according to the modem of the datalink kit. Click on your corresponding modem:

- [Datalink Kit A/B/C - Veronte SDL modem](#)
- [Datalink Kit D - DTC modem](#)
- [Datalink Kit F/G - Silvus modem](#)
- [Datalink Kit H/I - MicroHard modem](#)
- [Datalink Kit J/K - Amplified Veronte SDL modem](#)

### Datalink Kit A/B/C - Veronte SDL Modem

1. First of all, to access the expansion bay, read [Expansion Bay Access - Hardware Installation](#) section of this manual. It will not be necessary to take out the bay plate.
2. Screw the modem to the plate with four mushroom bolts M3 x 4.

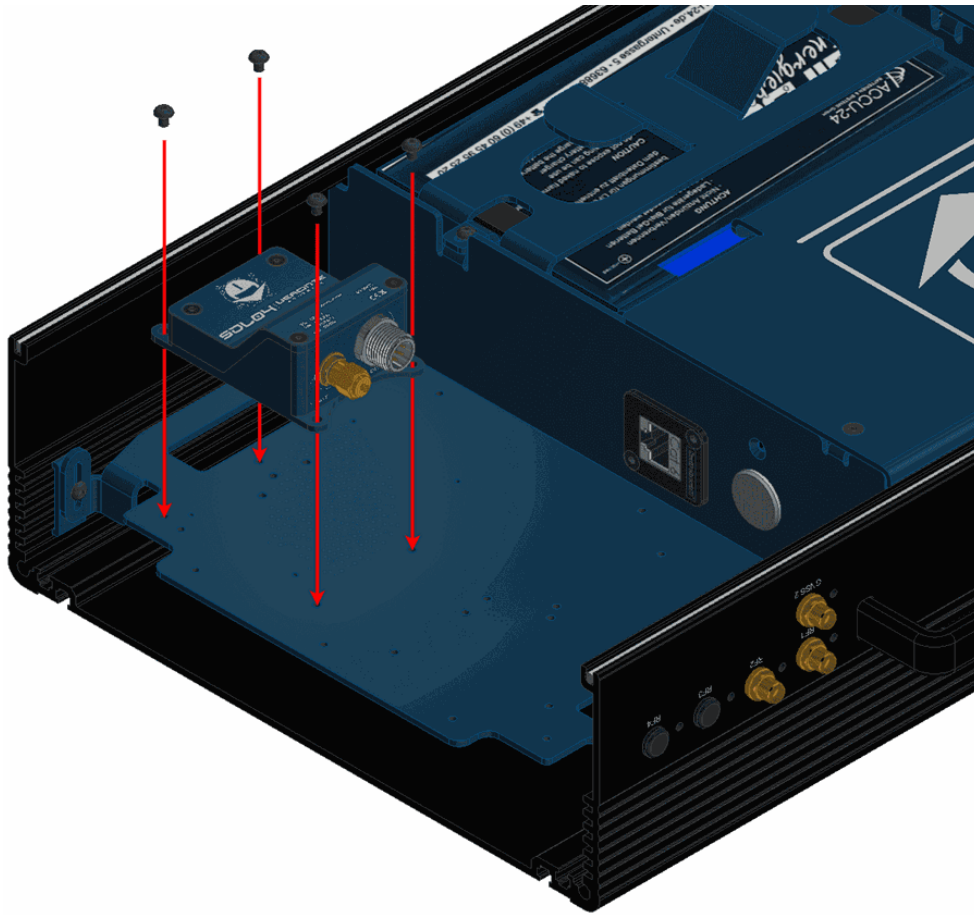

### Hardware SDL installation - Step 2

3. Wire the modem to the **bay connector** and **RF2**.

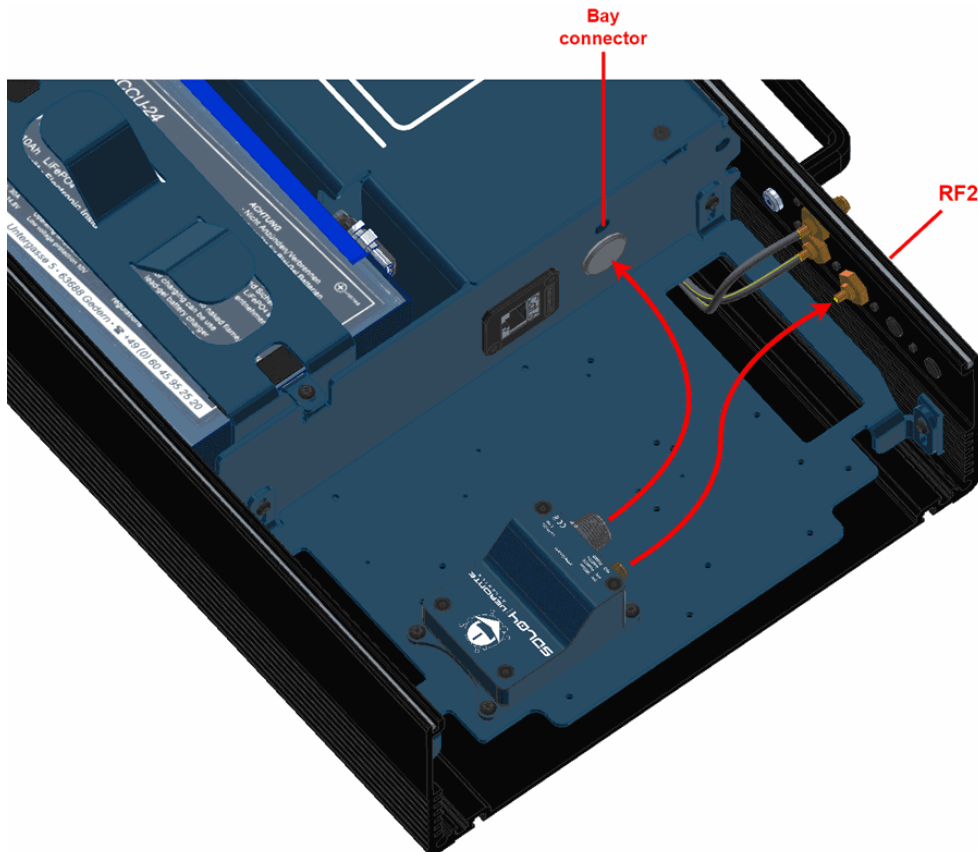

### Hardware SDL installation - Step 3

4. Mount the **PCS** to the pole according to [Pole Mount Installation - Hardware Installation](#) section of this manual (do not close the expansion bay yet).
5. Attach the omnidirectional antenna to the pole mount.

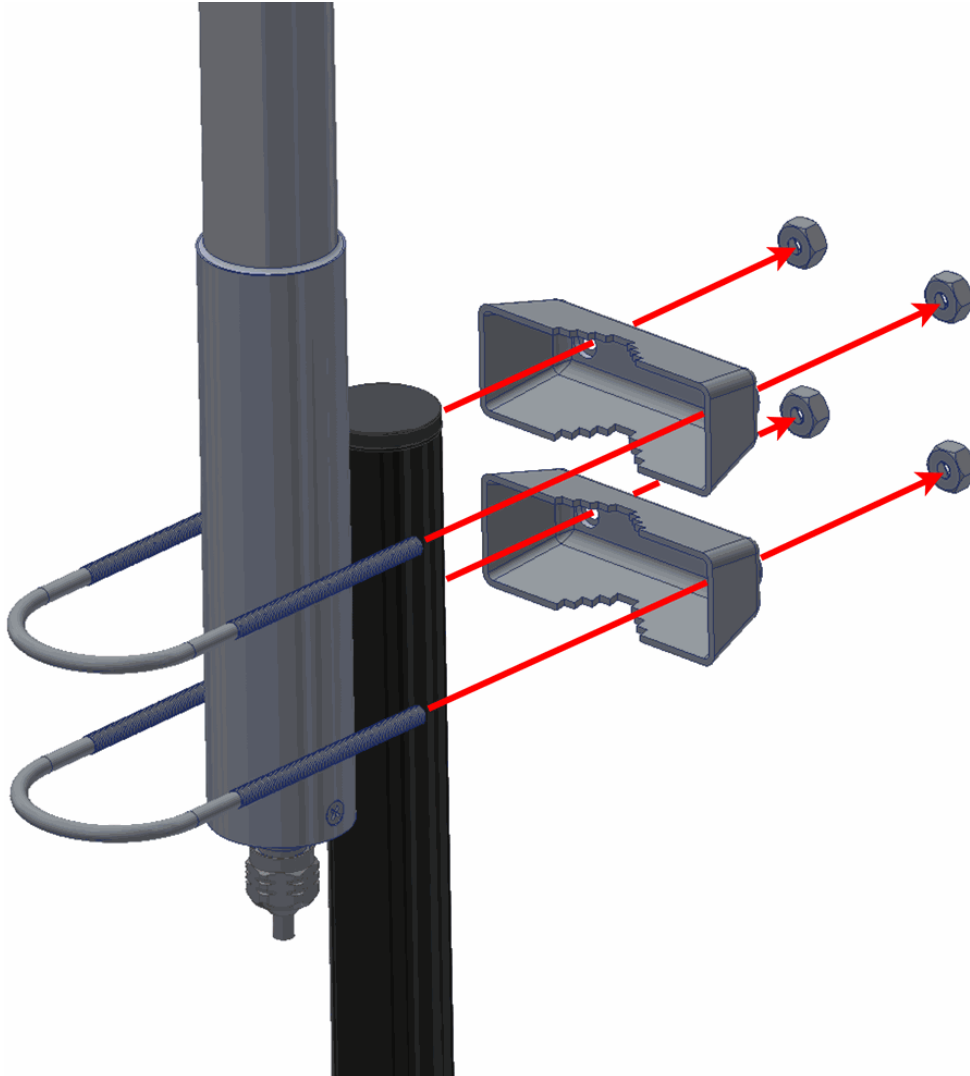

### Hardware SDL installation - Step 5

6. Wire the antennas to the **PCS**.

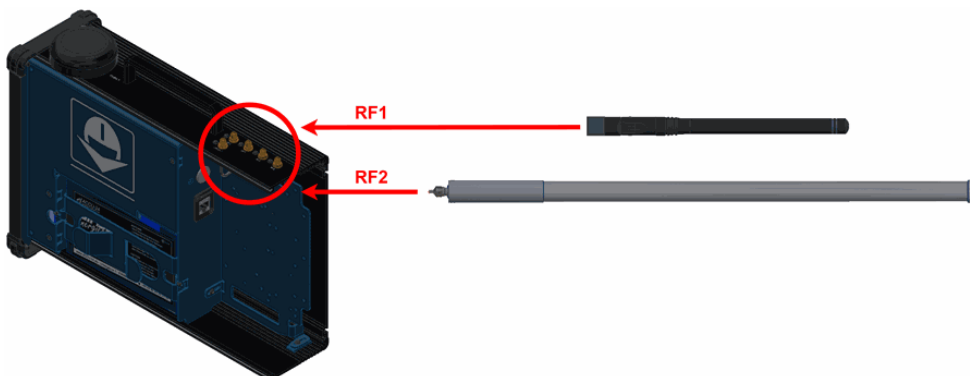

---

## Hardware SDL installation - Step 6 (Diagram not scaled)

7. Configure the **Veronte Autopilot 1x** as explained in [External radios - Integration examples](#) section of **1x PDI Builder** user manual.
8. Configure the **Veronte Autopilot 1x** to communicate with **SDL** through a tunnel, to do it read [Tunnel - Input/Output](#) section of **1x PDI Builder** user manual.
9. Once the tunnel communication is established through **Autopilot 1x**, the modem can be configured with AT commands.
  1. To understand the basics, first of all, read [How to configure SDL - Software Installation](#) section of **SDL User Manual**.
  2. After that, read [Veronte Autopilot 1x - Integration Examples](#) section of **SDL User Manual**, to configure the **SDL** according to the autopilot used.
10. Once the **SDL** and the **Autopilot 1x** have been configured, close the **PCS**.

## Datalink Kit D - DTC Modem

1. First of all, to access the expansion bay, read [Expansion Bay Access - Hardware Installation](#) section of this manual.
2. Screw the following components to the bay plate, placing both thermal pads:
  - Use two mushroom bolts M3 x 20 for the radio modem.
  - Four mushroom bolts M3 x 5 for the amplifier.

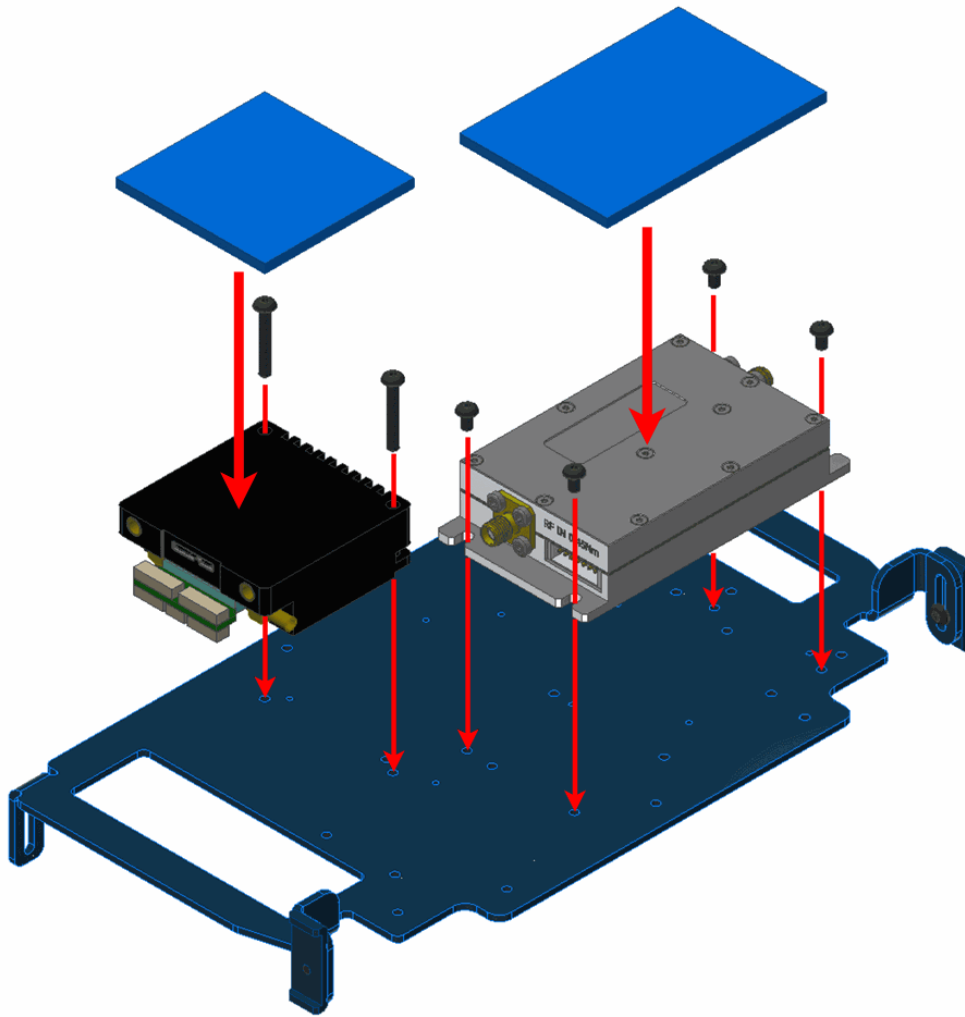

**Hardware DTC installation - Step 2**

3. On the opposite side of the plate, screw the ethernet connector with two mushroom bolts M3 x 8 and both spacers.

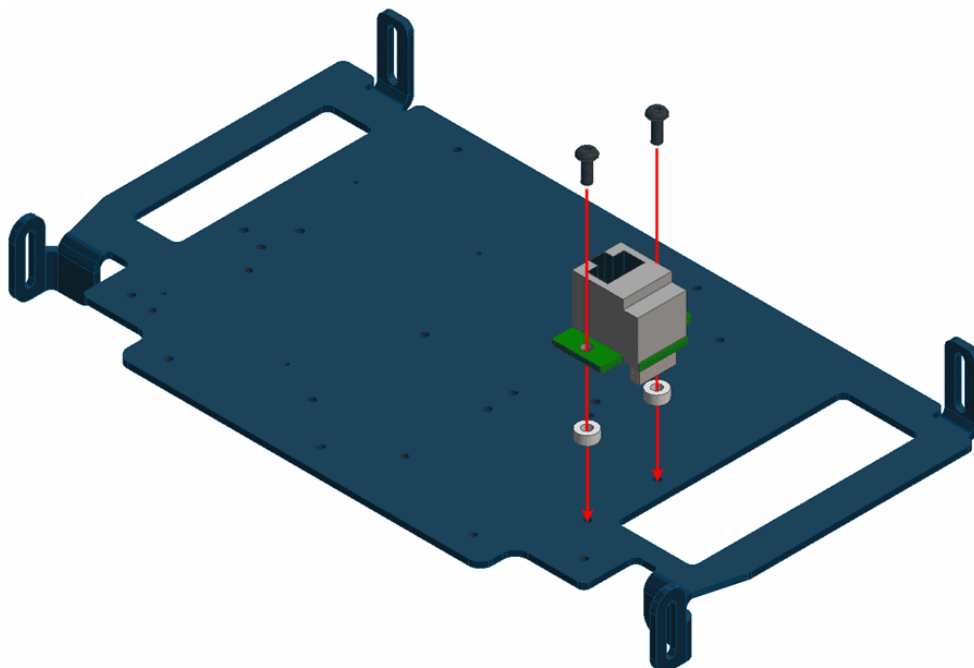

**Hardware DTC installation - Step 3**

4. Connect the bay harness to the expansion bay connector. Harness, modem and amplifier are already wired, then it is only required to plug the harness to the bay connector.

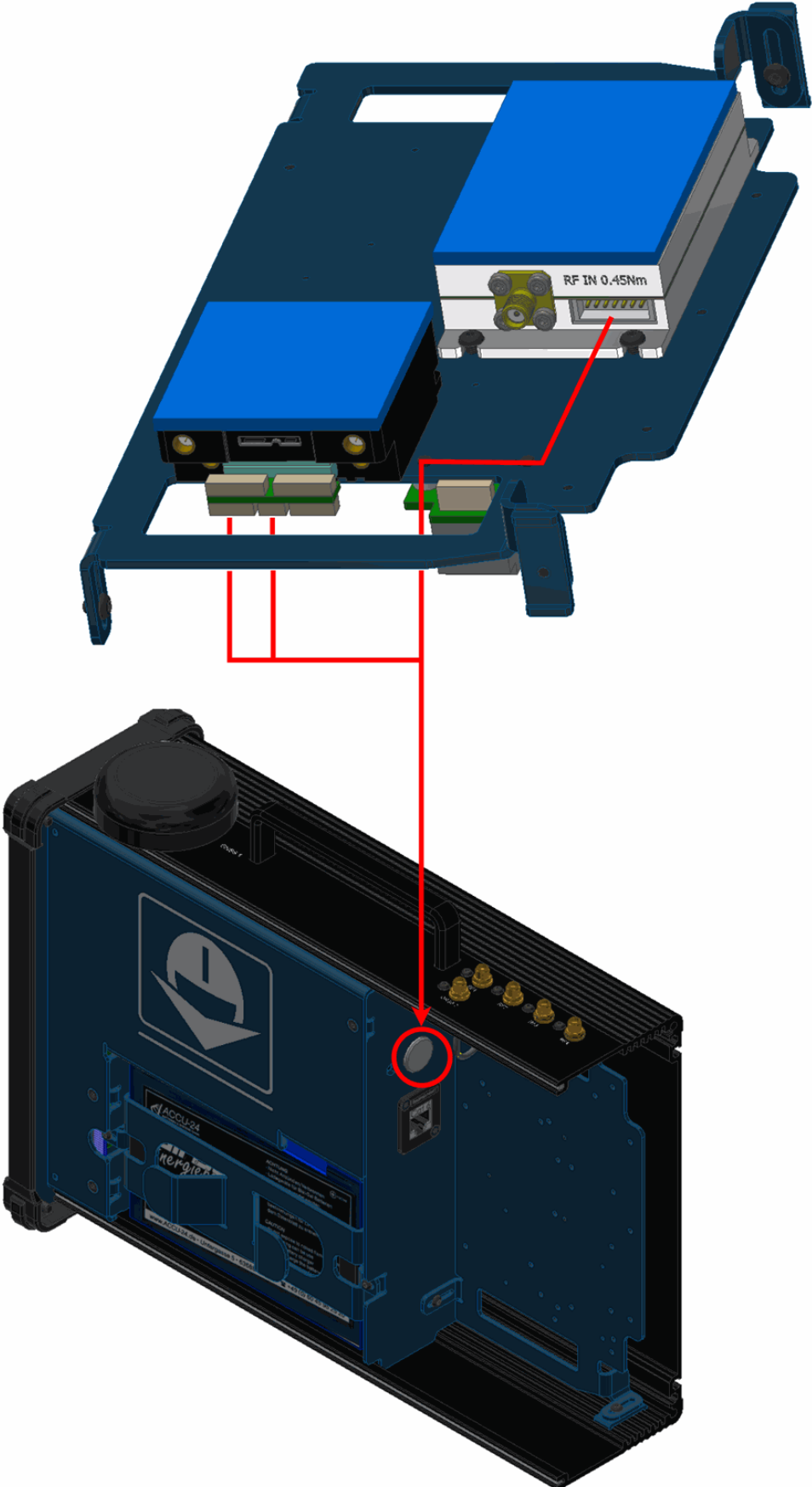

**Hardware DTC installation - Step 4  
(Diagram not scaled)**

5. Connect the amplifier and the radio modem.

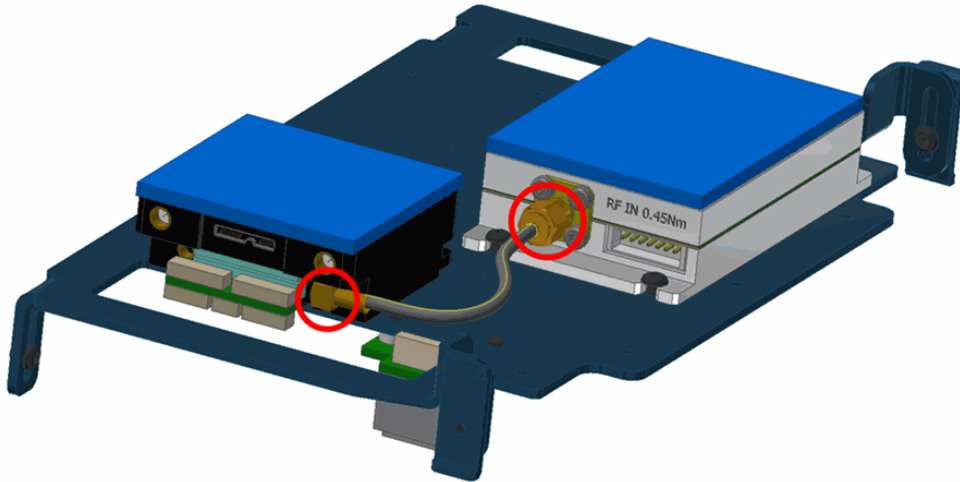

**Hardware DTC installation - Step 5**

6. Connect the amplifier to **RF2** passing the cable through the plate hole.

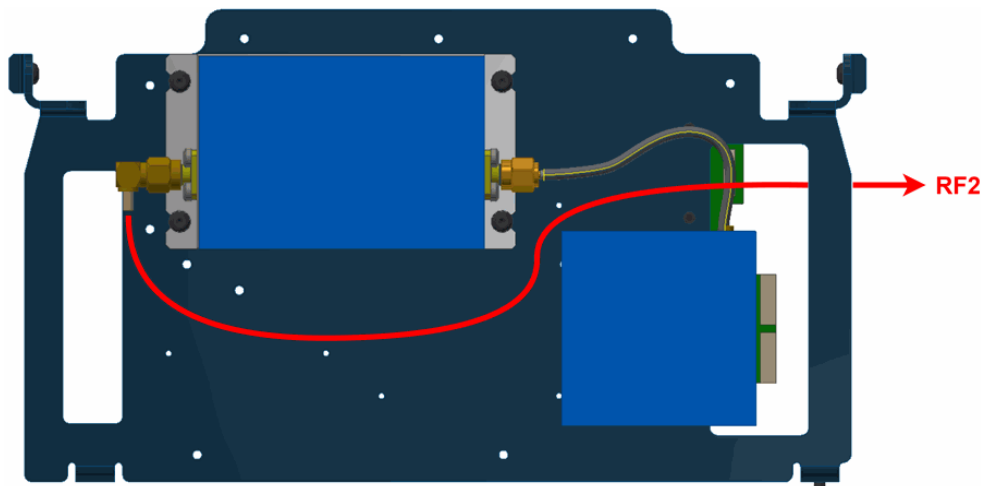

**Hardware DTC installation - Step 6**

7. Connect the modem to **RF3**, passing the cable through the plate hole.

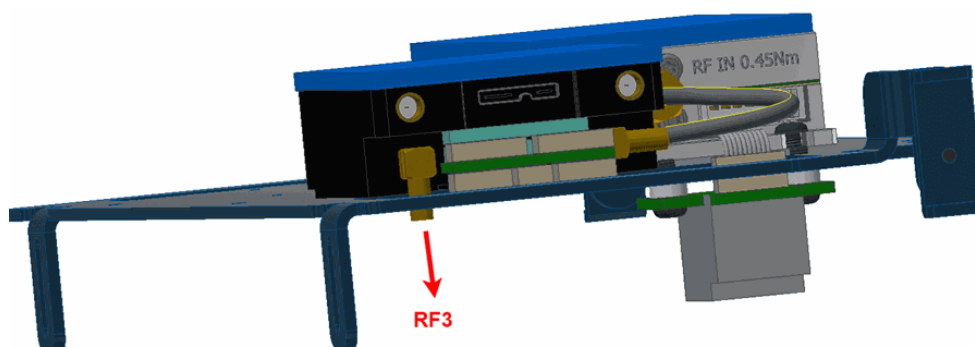

**Hardware DTC installation - Step 7**

8. Place again the bay plate into the **PCS**, it should result as the following image:

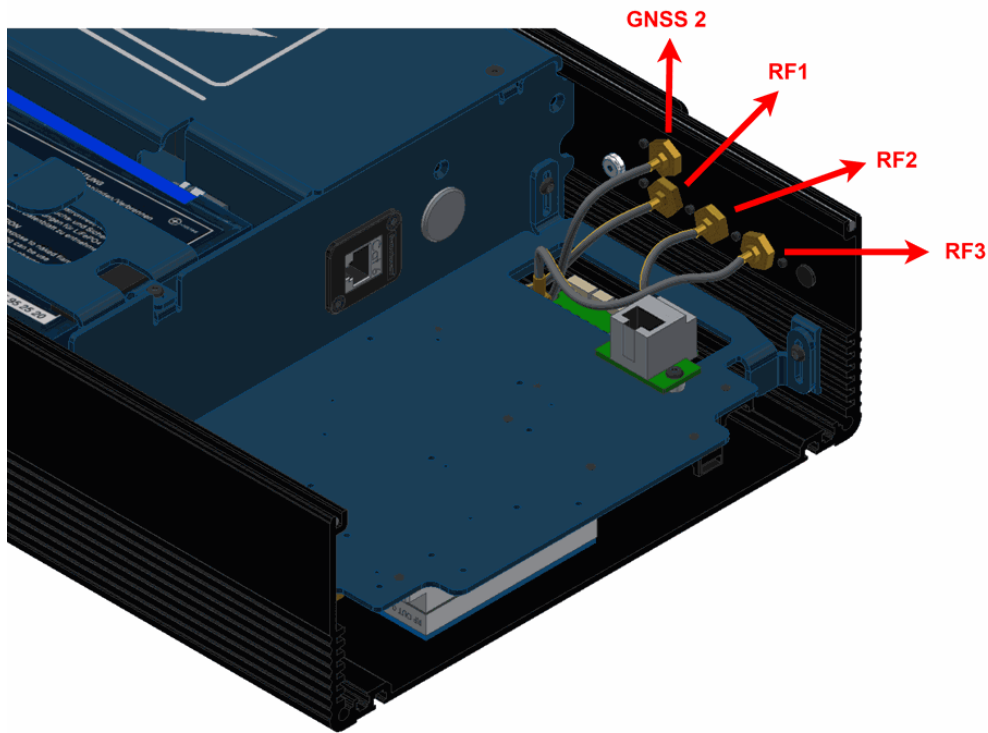

### Hardware DTC installation - Step 8

9. Attach the **PCS** to the pole according to [Pole Mount Installation - Hardware Installation](#) section of this manual (do not close the expansion bay yet).
10. Fix both antennas to the holder with the knobs.

#### **Important**

If the user desires **to tilt an antenna, ignore this step** and read the [Adjustable Antenna Mount - Hardware Installation](#) section of this manual.

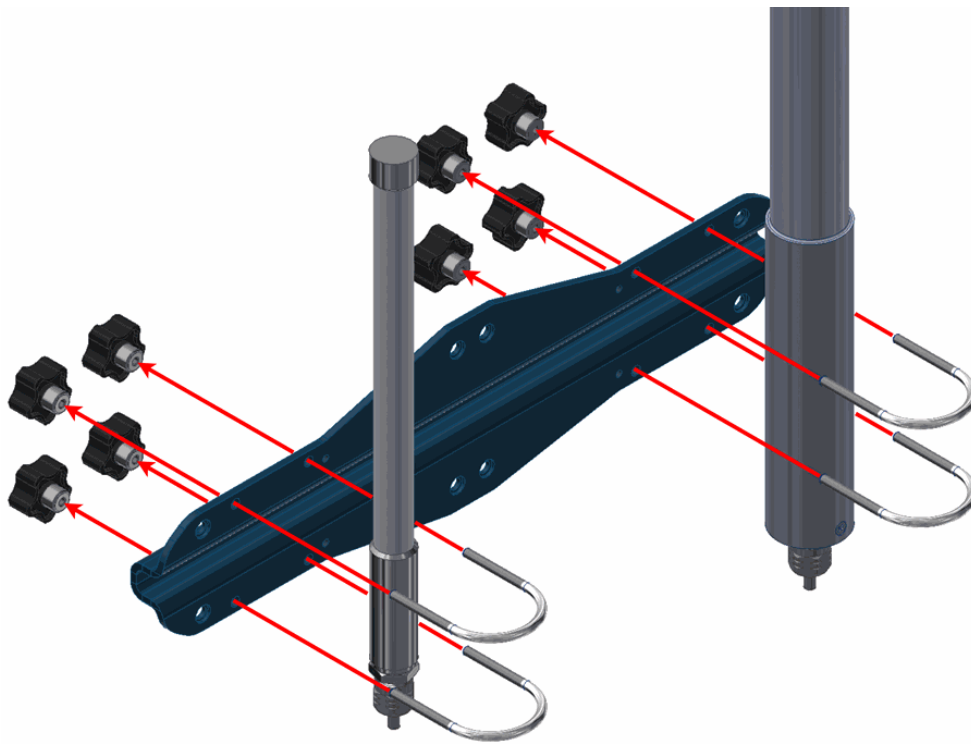

**Hardware DTC installation - Step 10**

11. Join the holder to the pole with the wall bracket.

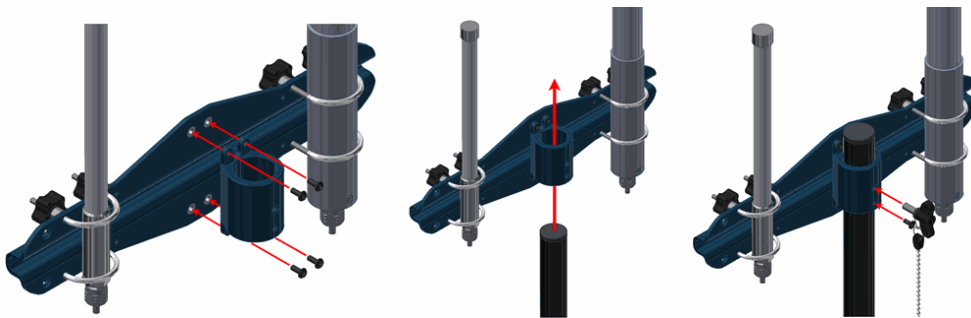

**Hardware DTC installation - Step 11**

12. Wire the antennas.

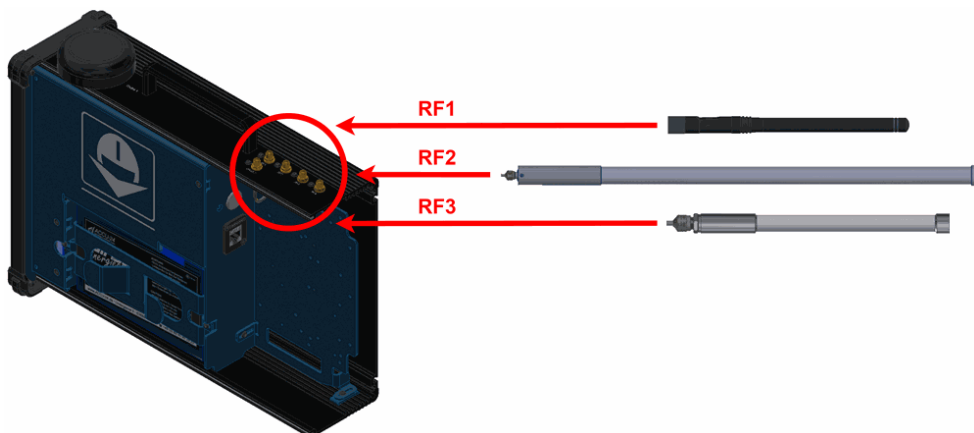

**Hardware DTC installation - Step 12  
(Diagram not scaled)**

13. Connect the computer to the ethernet cable.

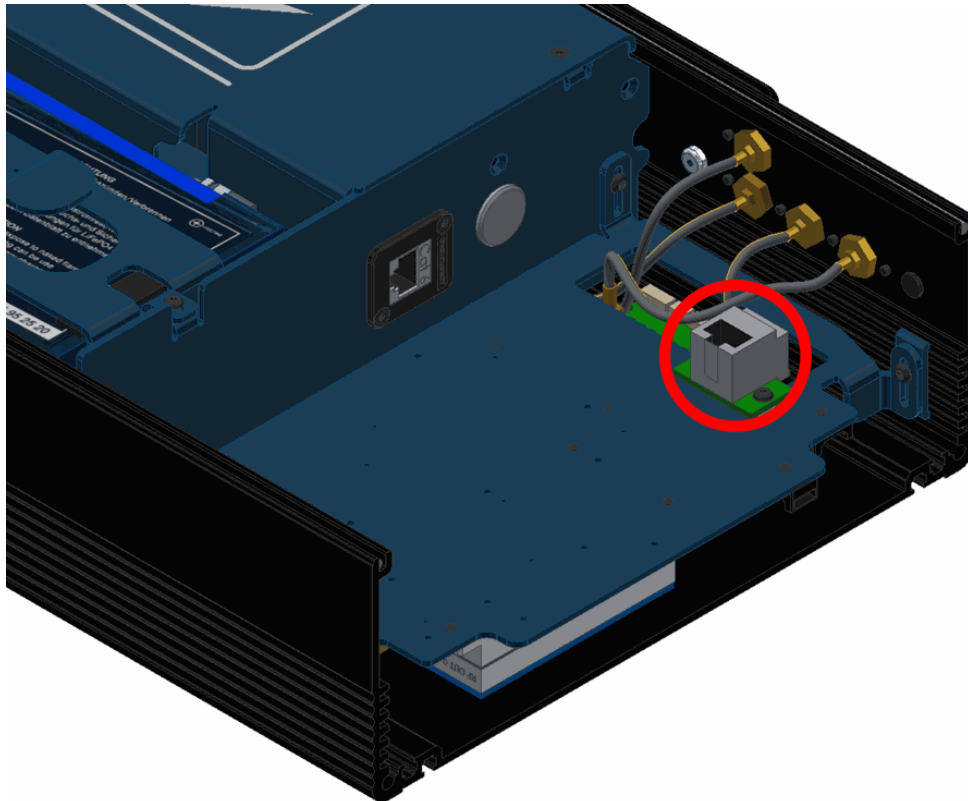

### Hardware DTC installation - Step 13

14. Make sure computer is set to static IP address on same subnet as radio. The following substeps clarify how to set the IP address:

1. Open **Network and sharing centre** and click **Change adapter settings**.

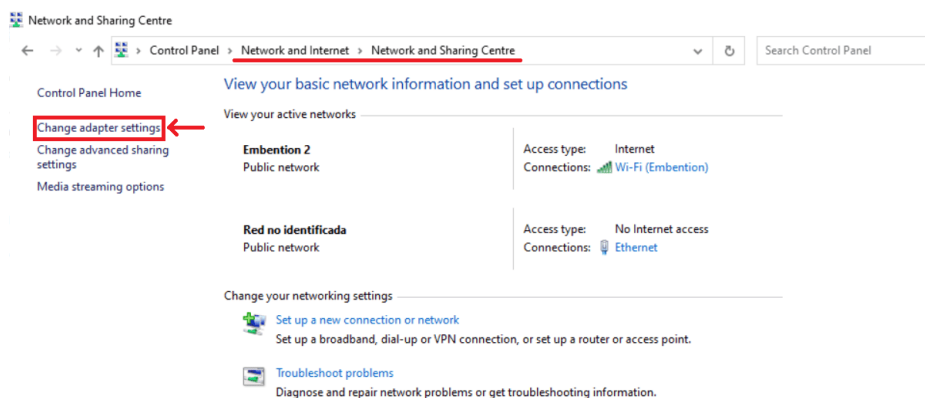

2. Select **Local Area Connection**, right click, and select **Properties**.

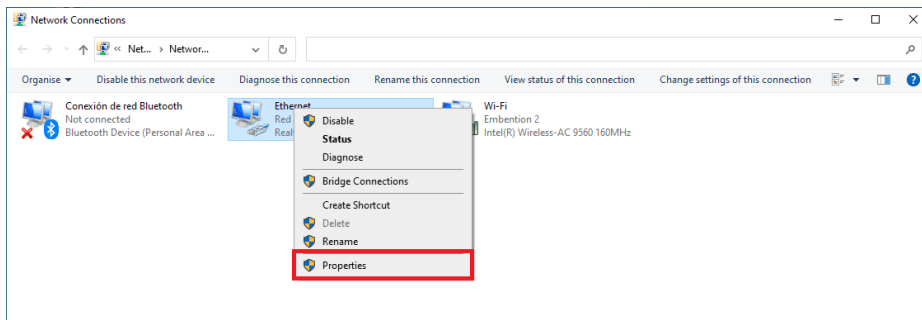

3. Select **IPv4** and click **Properties**.

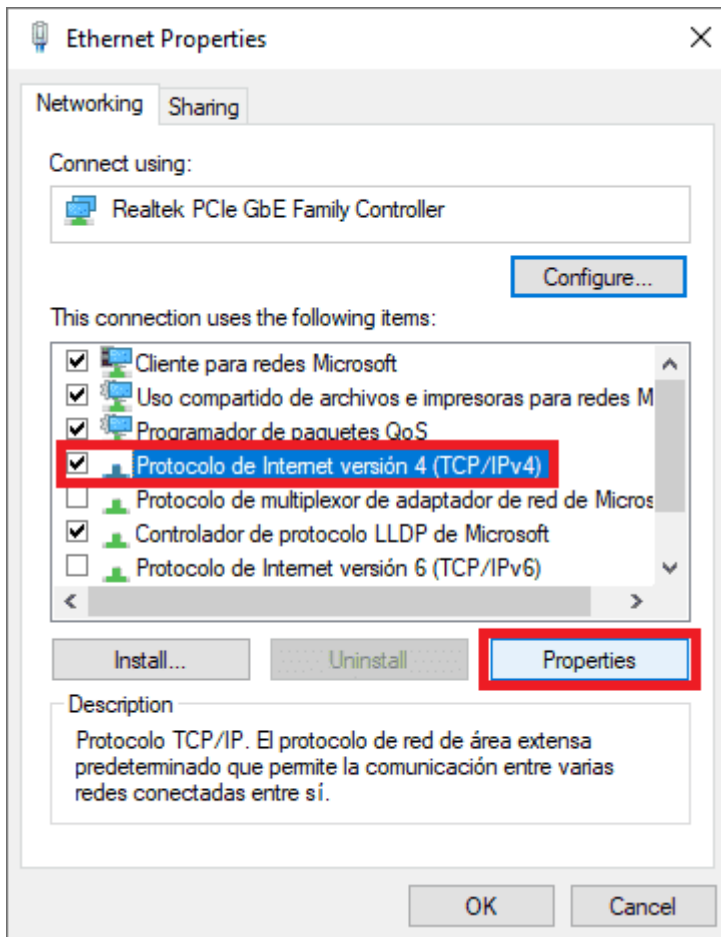

4. Set IP address to 192.168.8.3. Set the Subnet mask to 255.255.255.0 and click **OK**.

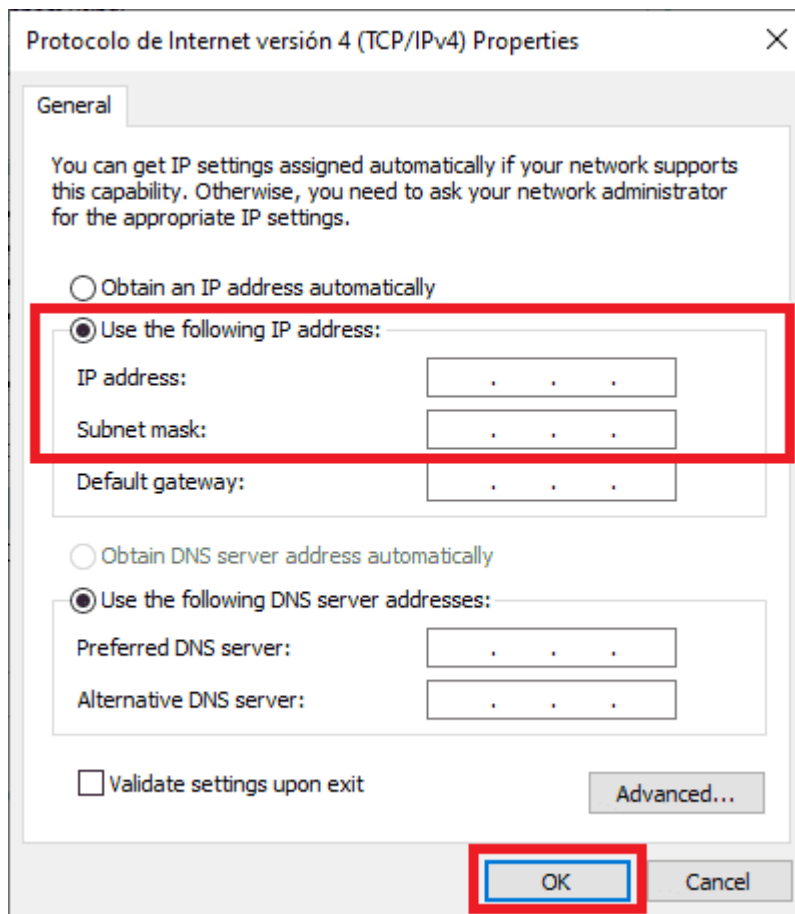

15. Open a browser and introduce the radio address on the search bar 192.168.8.95. To know more details about the configuration, read [DTC radio configuration - Integration examples](#) section of **1x Hardware Manual**.
16. Configure the **Veronte Autopilot 1x** according to [External radios - Integration examples](#) section of **1x PDI Builder** user manual.
17. Calibrate the modem to the desired power.
18. Once the modem and the **Autopilot 1x** have been configured, close the **PCS**

## Datalink Kit F/G - Silvus Modem

### Hardware Installation

1. First of all, to access the expansion bay, read [Expansion Bay Access - Hardware Installation](#) section of this manual.
2. Screw the switch against the plate with the switch support and two mushroom bolts M3 x 5.

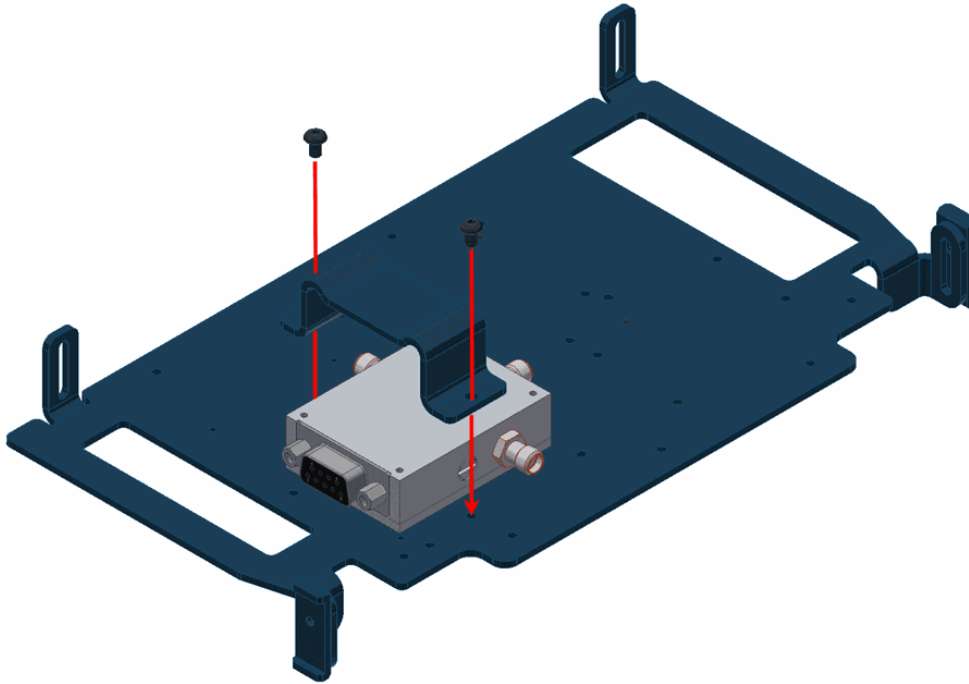

### Hardware Silvus installation - Step 2

3. Attach the switch connector.

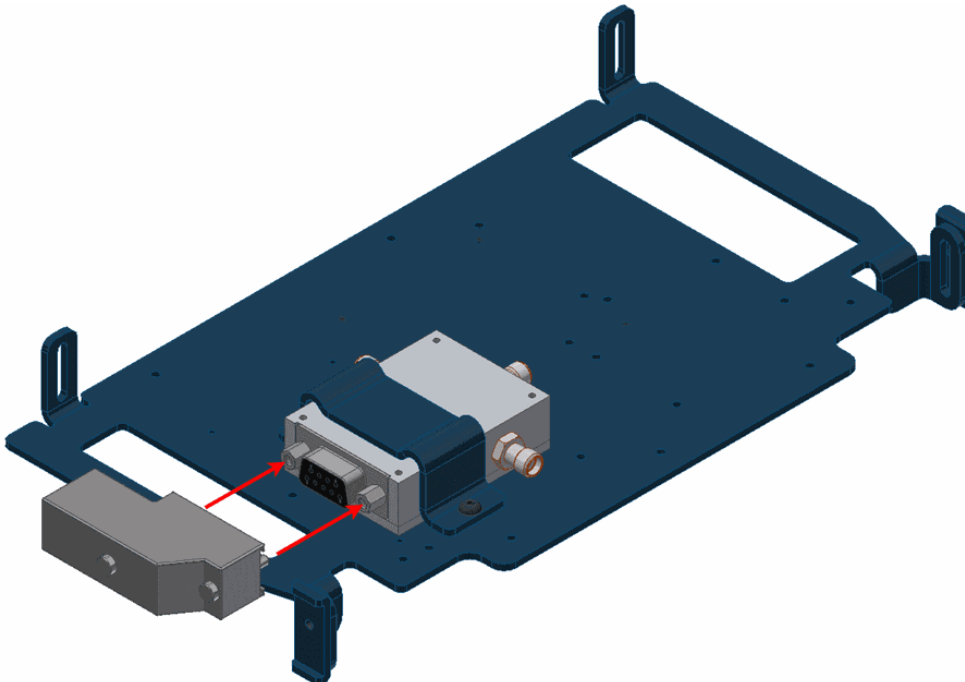

### Hardware Silvus installation - Step 3

4. Screw the modem on the opposite side of the plate with four screws M2 x 20. Place two thermal pads on the top and the bottom.

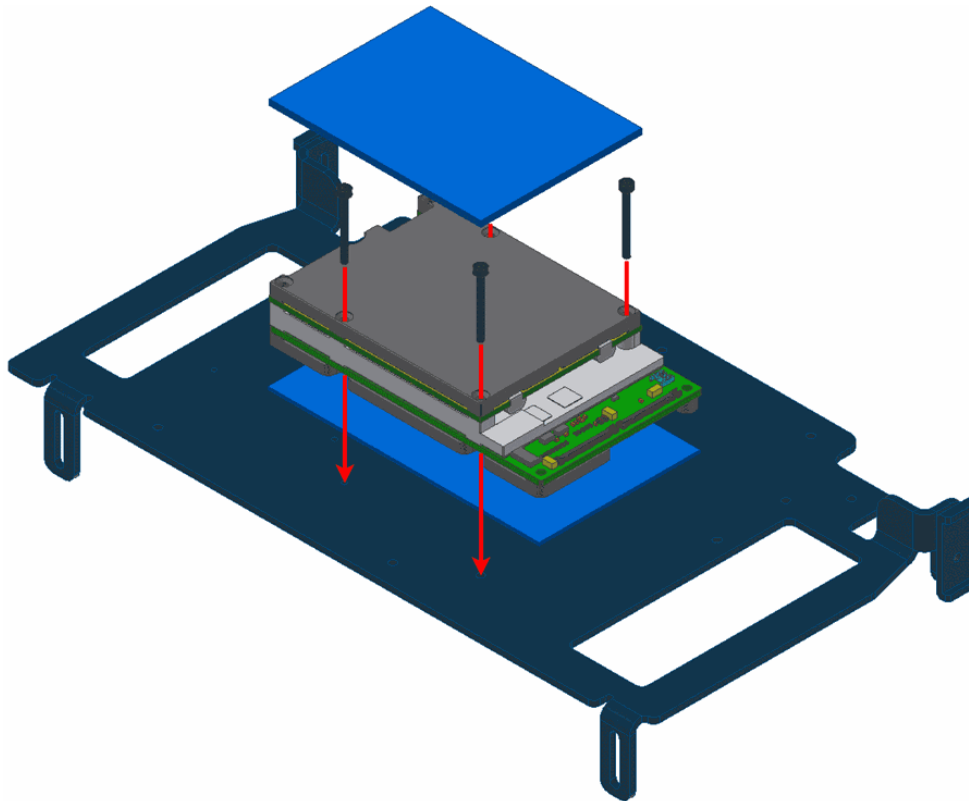

**Hardware Silvus installation - Step 4**

5. Connect the modem to the switch as indicated in the following figure:

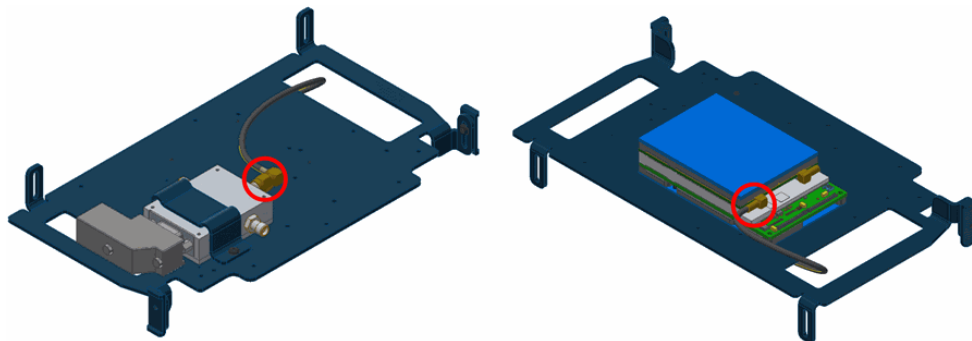

**Hardware Silvus installation - Step 5**

6. Place the plate in the PCS and connect the indicated modem connector to the **RF2**.

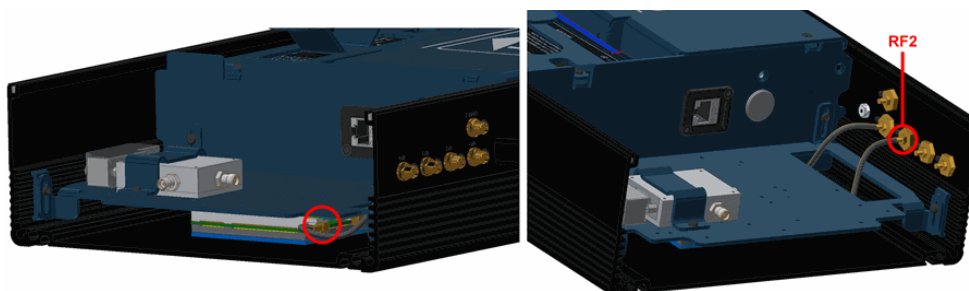

**Hardware Silvus installation - Step 6**

7. Connect the switch to **bay connector, RF3** and **RF4**.

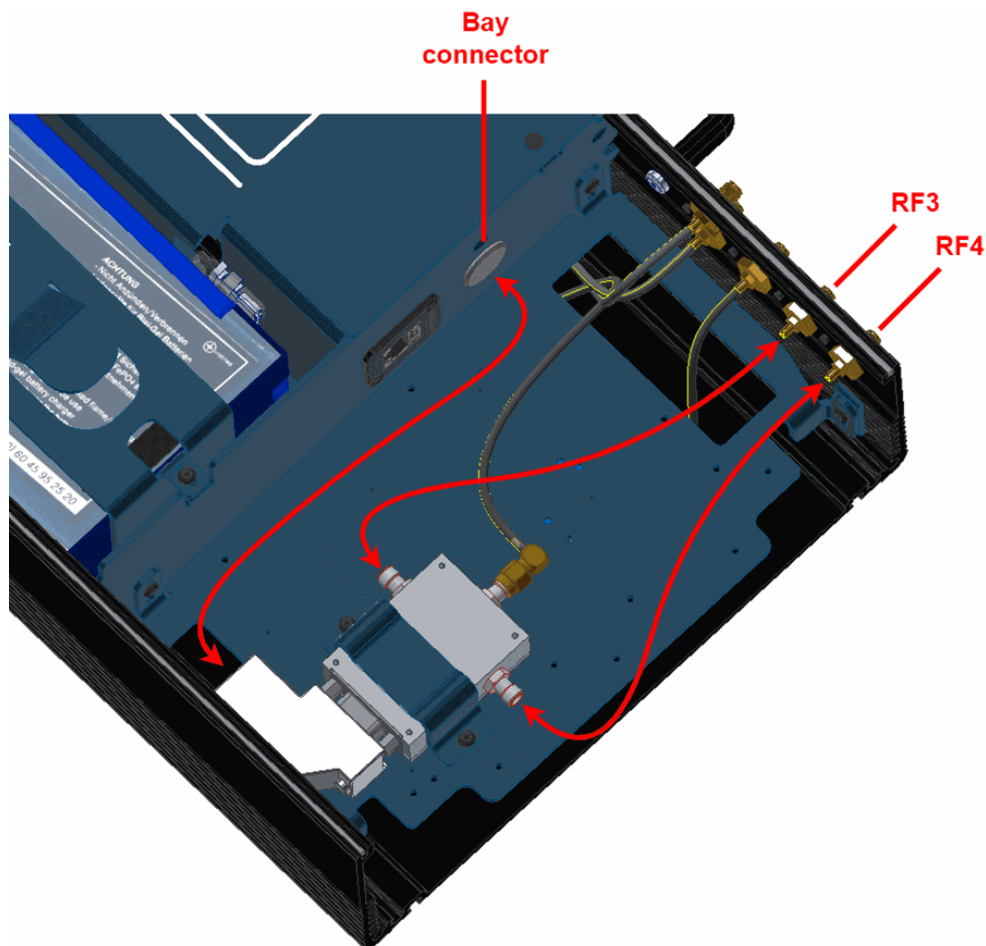

### Hardware Silvus installation - Step 7

8. Attach the **PCS** to the pole according to [Pole Mount Installation - Hardware Installation](#) section of this manual (do not close the expansion bay yet).
9. Fix both antennas to the holder with the knobs.

#### ⚠ Important

If the user desires **to tilt an antenna, ignore this step** and read the [Adjustable Antenna Mount - Hardware Installation](#) section of this manual.

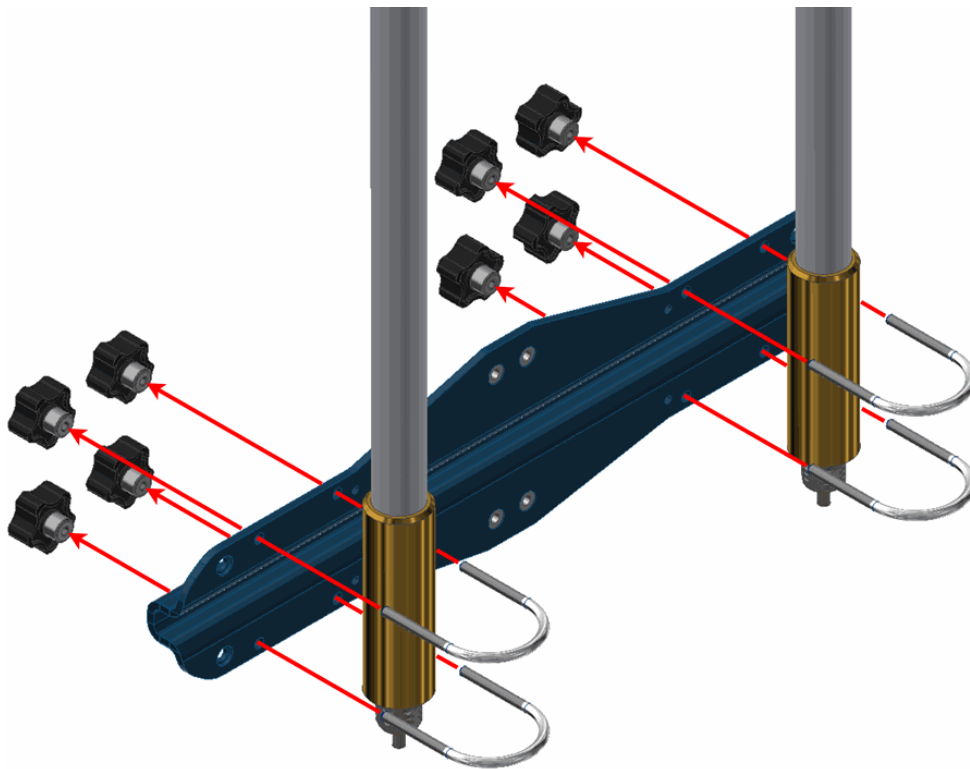

**Hardware Silvus installation - Step 9**

10. Join the holder to the pole with the wall bracket.

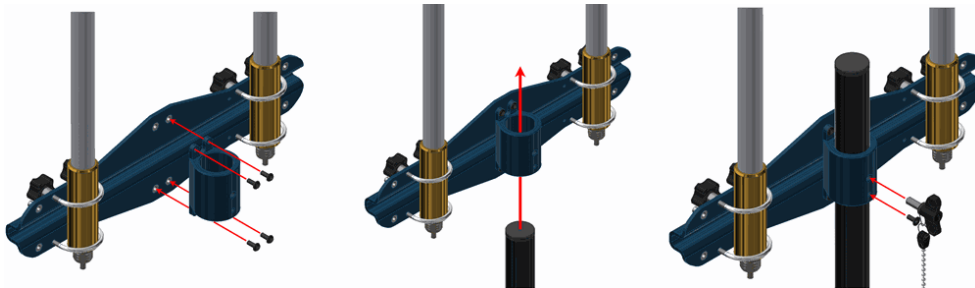

**Hardware Silvus installation - Step 10**

11. Wire the antennas. In case of using a **Veronte T28** with the **PCS**, the wiring is different.

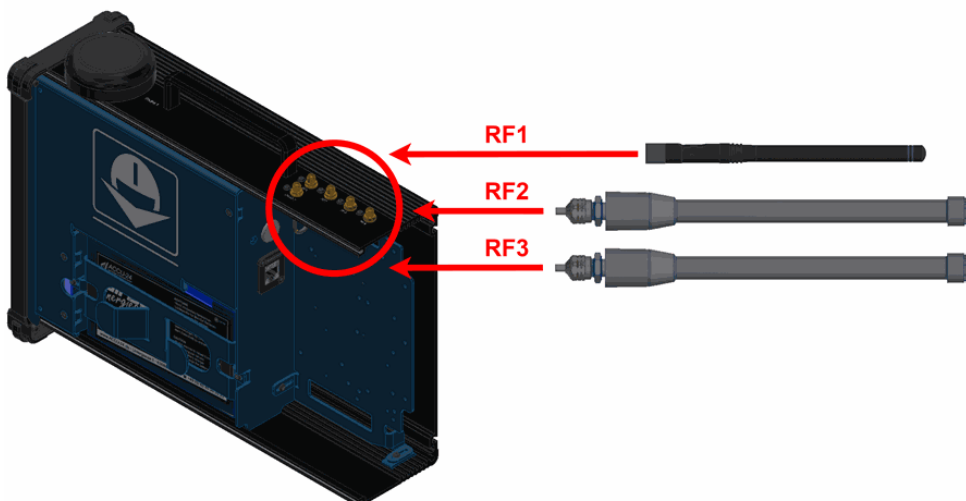

**Wiring with only PCS  
(Diagram not scaled)**

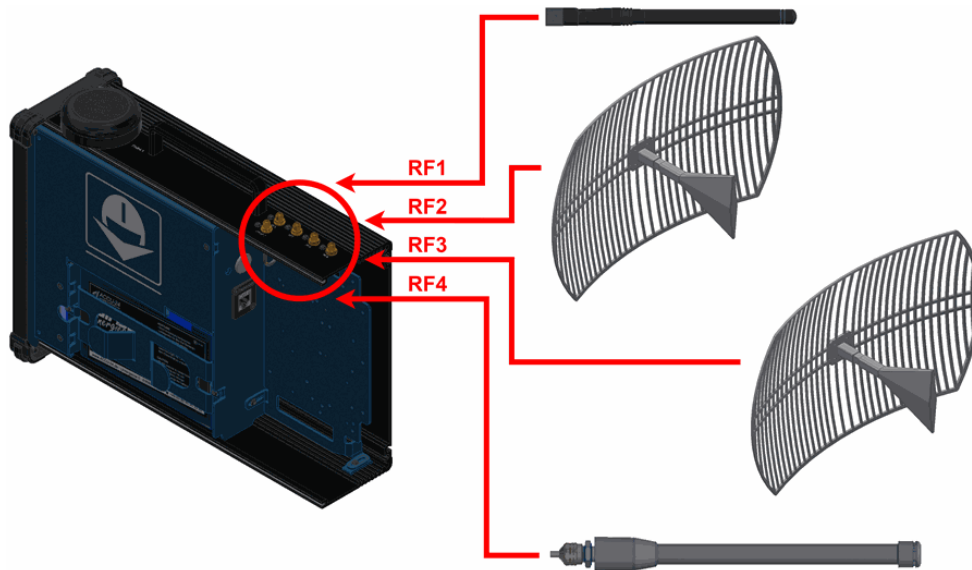

**Wiring with PCS and T28  
(Diagram not scaled)**

**Tip**

Do not close the **PCS** until all configurations are finished.

Silvus radio configuration

To know how to do a basic configuration of the Silvus radio, visit [Silvus radio configuration - Integration examples](#) section of **1x Hardware Manual**.

However, an additional configuration is required when working with a PCS instead of the GND unit of Veronte Autopilot 1x.

- Networking. LAN Settings

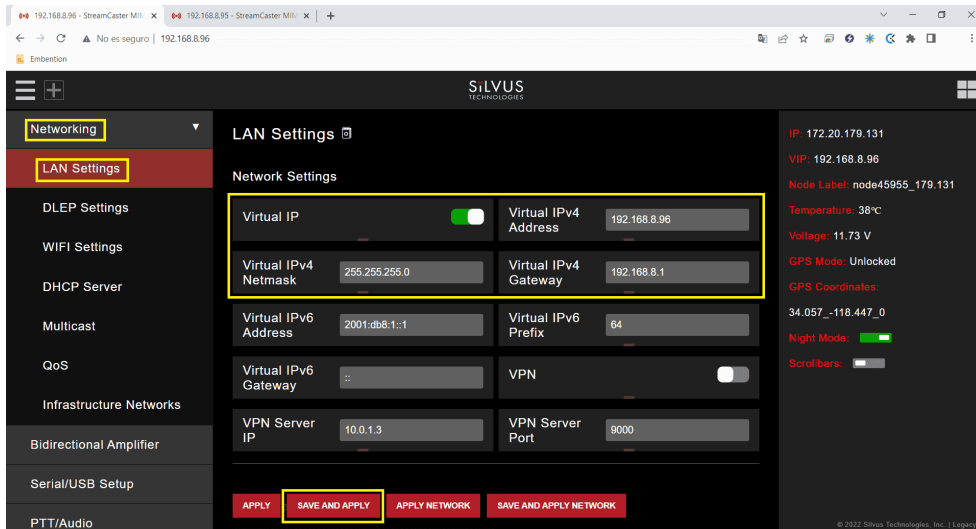

### LAN Settings panel air unit

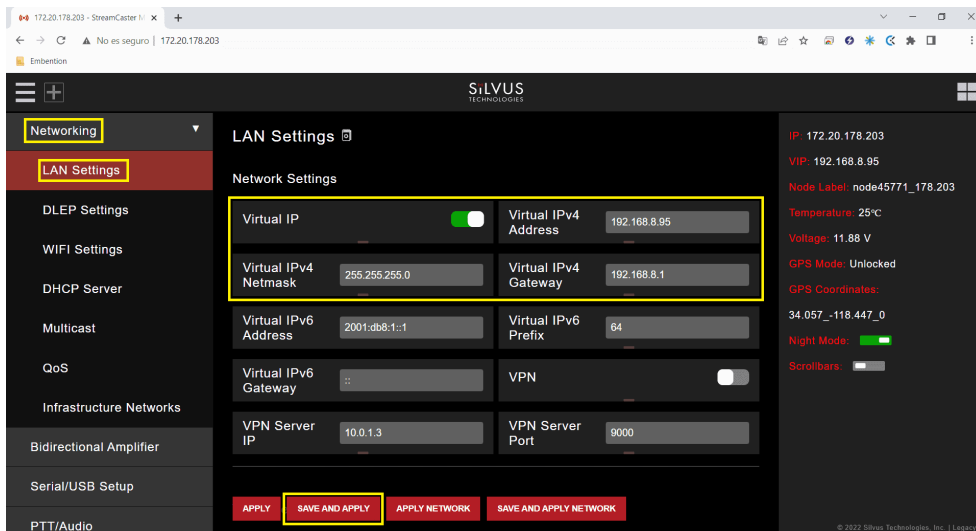

### LAN Settings panel PCS

- **Virtual IP:** Enable or Disable the Secondary IP address for the radio.  
**Enable**
- **Virtual IPv4 Address:** Set the secondary IP address for the radio. The user can set any IP address, we have chosen 192.168.96 for the radio connected to the air unit and 192.168.95 for the radio linked to the PCS.
- **Virtual IPv4 Netmask:** Netmask for the Secondary IP address, e.g. 255.255.255.0.
- **Virtual IPv4 Gateway:** Gateway for local network to allow radio to connect to the internet. **192.168.8.1** is set because it is the IP address of the PCS router.

## Silvus radio configuracion on PC

To be able to access the StreamScape GUI of the radios once connected to the PCS, check that the **Network & Internet settings** of the PC are as shown in the following screenshots.

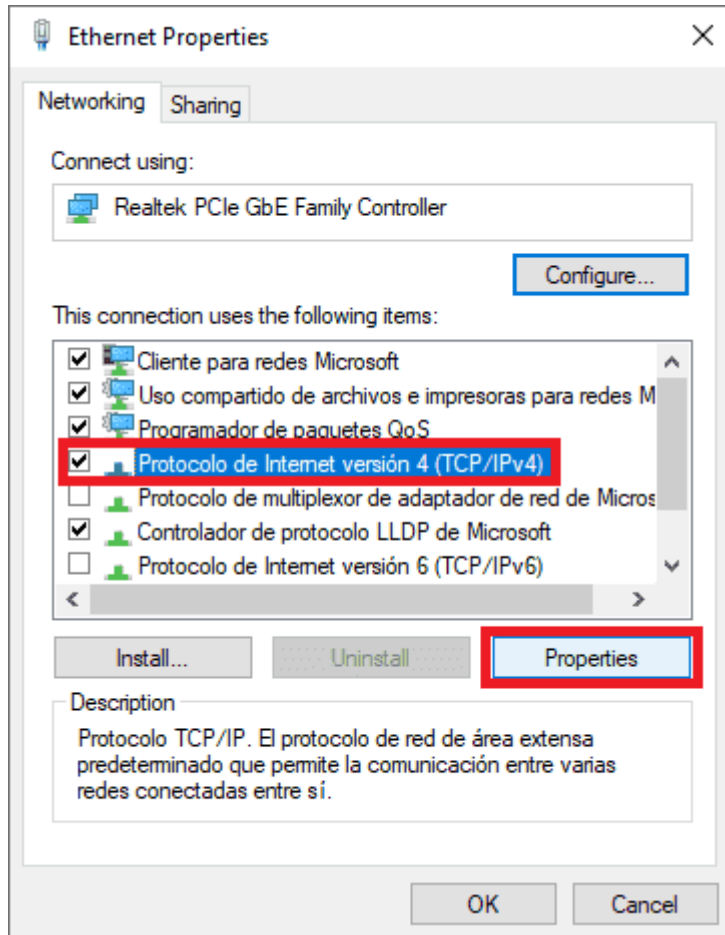

**Ethernet settings 1**

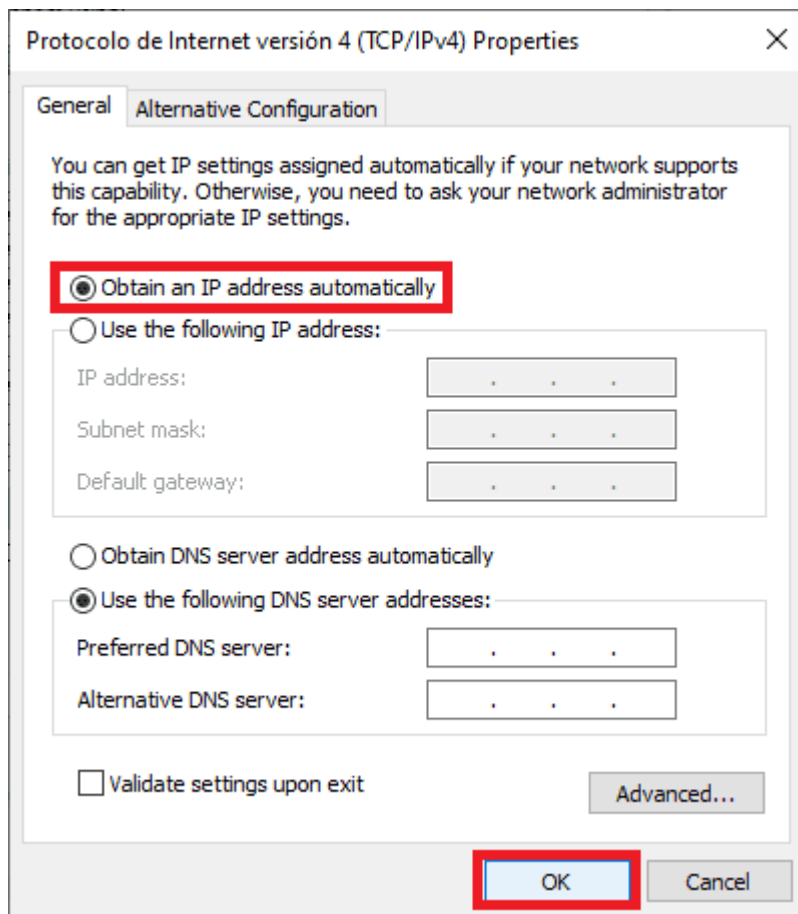

## Ethernet settings 2

### Note

This configuration is the same whether the PCS is connected via wifi or ethernet.

## Silvus radio configuration in autopilot

To configure an **Autopilot 1x** for a Silvus radio, visit [External radios - Integration examples](#) section of **1x PDI Builder** user manual.

## Datalink Kit H/I - MicroHard Modem

1. First of all, to access the expansion bay, read [Expansion Bay Access - Hardware Installation](#) section of this manual.
2. Screw the brackets against the plate with two M3 x 4 mushroom bolts, so that they grip the base of the radio module.

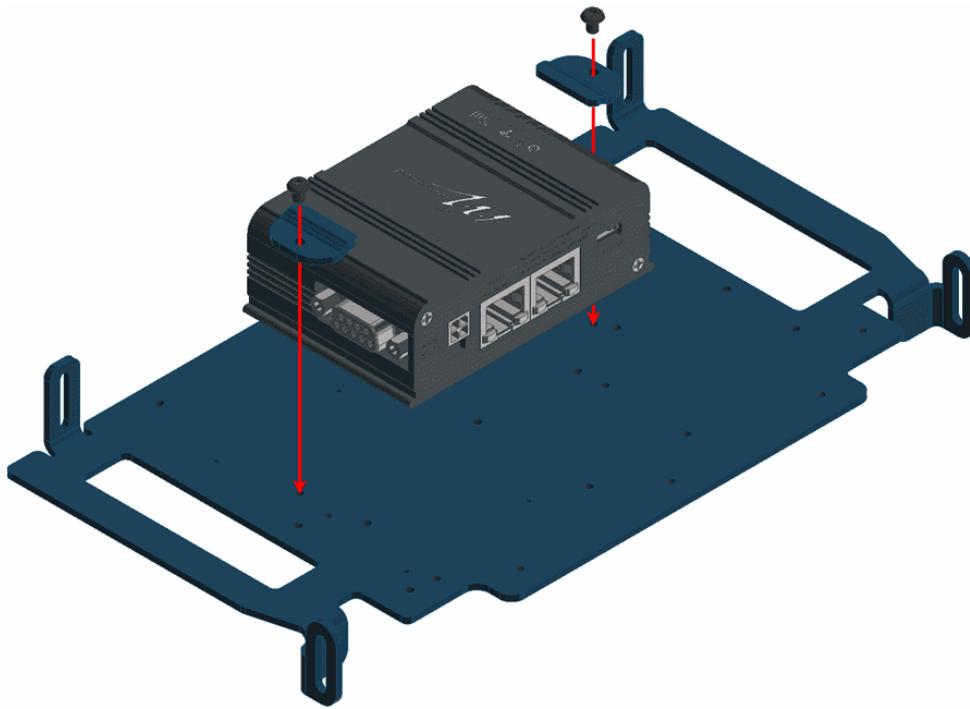

**MicroHard installation - Step 2**

3. Join the casing.

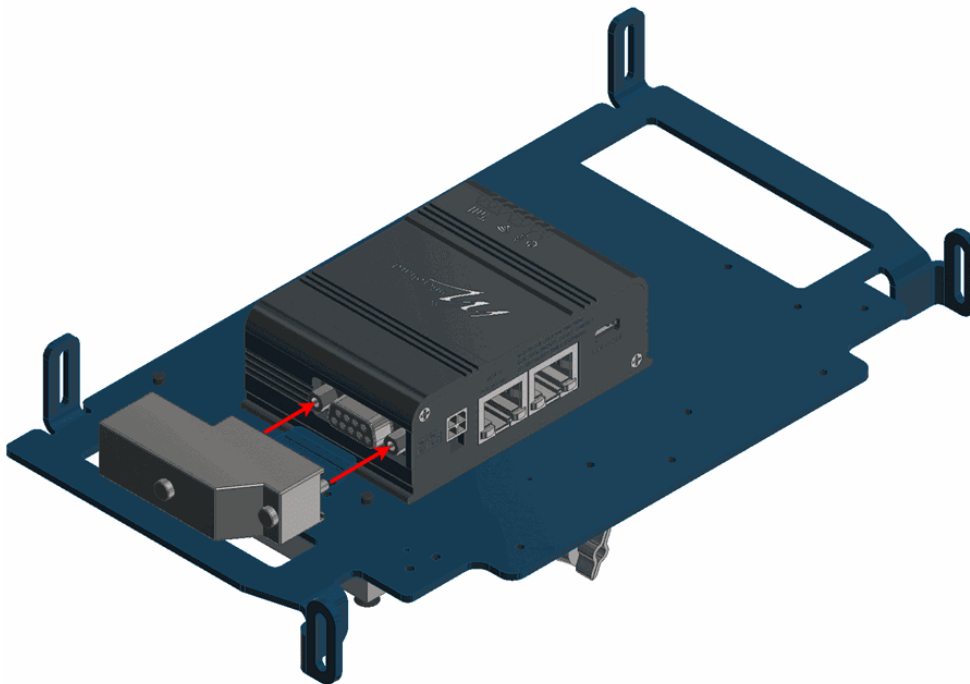

**MicroHard installation - Step 3**

4. On the opposite side of the bay; screw the amplifier with three countersunk screws M3 x 30 and apply the thermal pad.

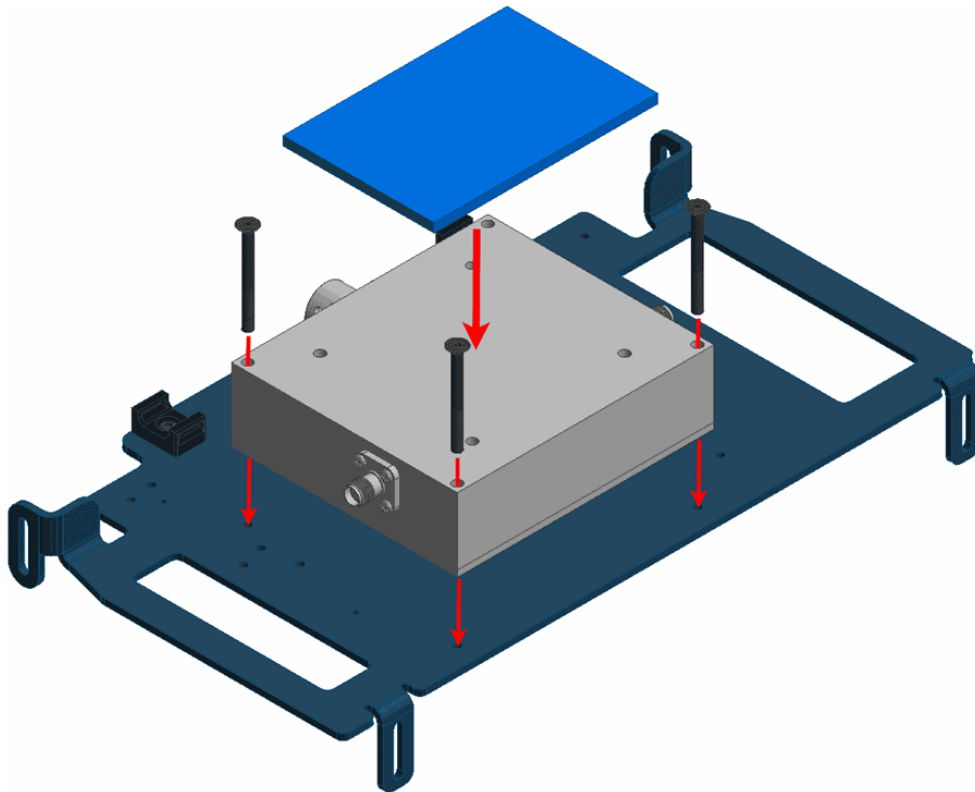

**MicroHard installation - Step 4**

5. Connect the modem and the amplifier as indicated by the following figure. Notice that the cable is passed through the plate hole.

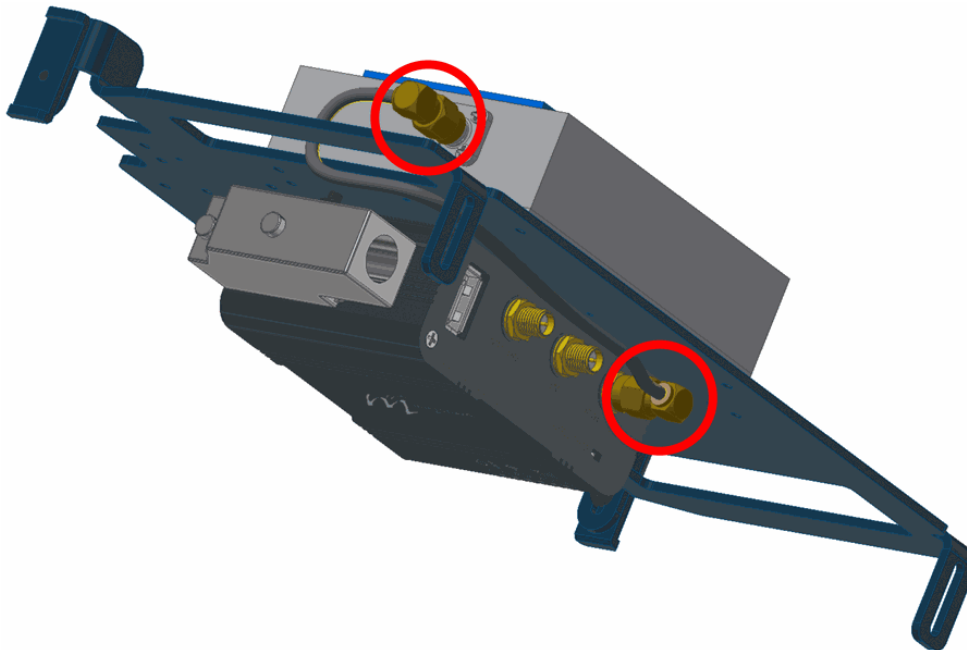

**MicroHard installation - Step 5**

6. Connect the amplifier to the **RF2** port. Again, the cable must be passed through the indicated hole.

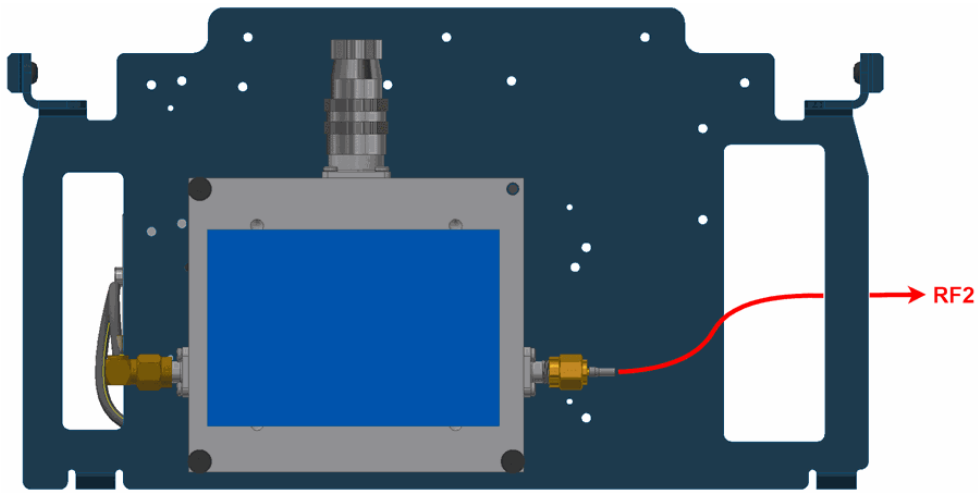

**MicroHard installation - Step 6**

7. Place and screw the bay plate as the following image:

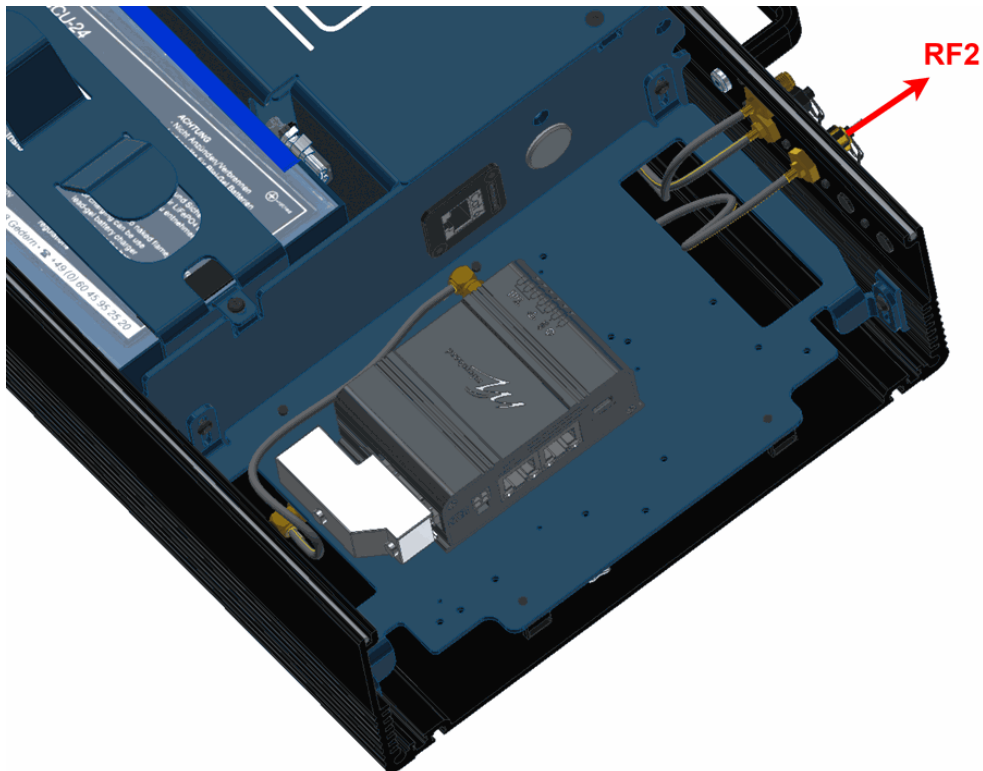

**MicroHard installation - Step 7**

8. Connect the modem to the expansion connector.

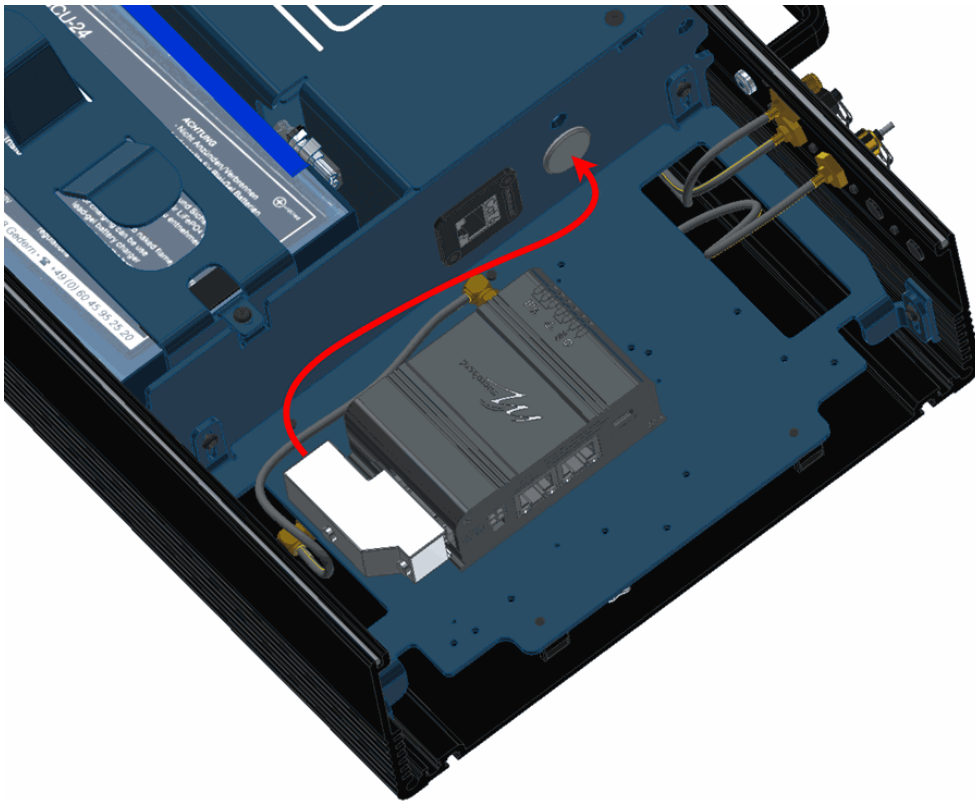

### MicroHard installation - Step 8

9. Mount the **PCS** to the pole according to [Pole Mount Installation - Hardware Installation](#) section of this manual (do not close the expansion bay yet).
10. Attach the omnidirectional antenna to the pole mount.

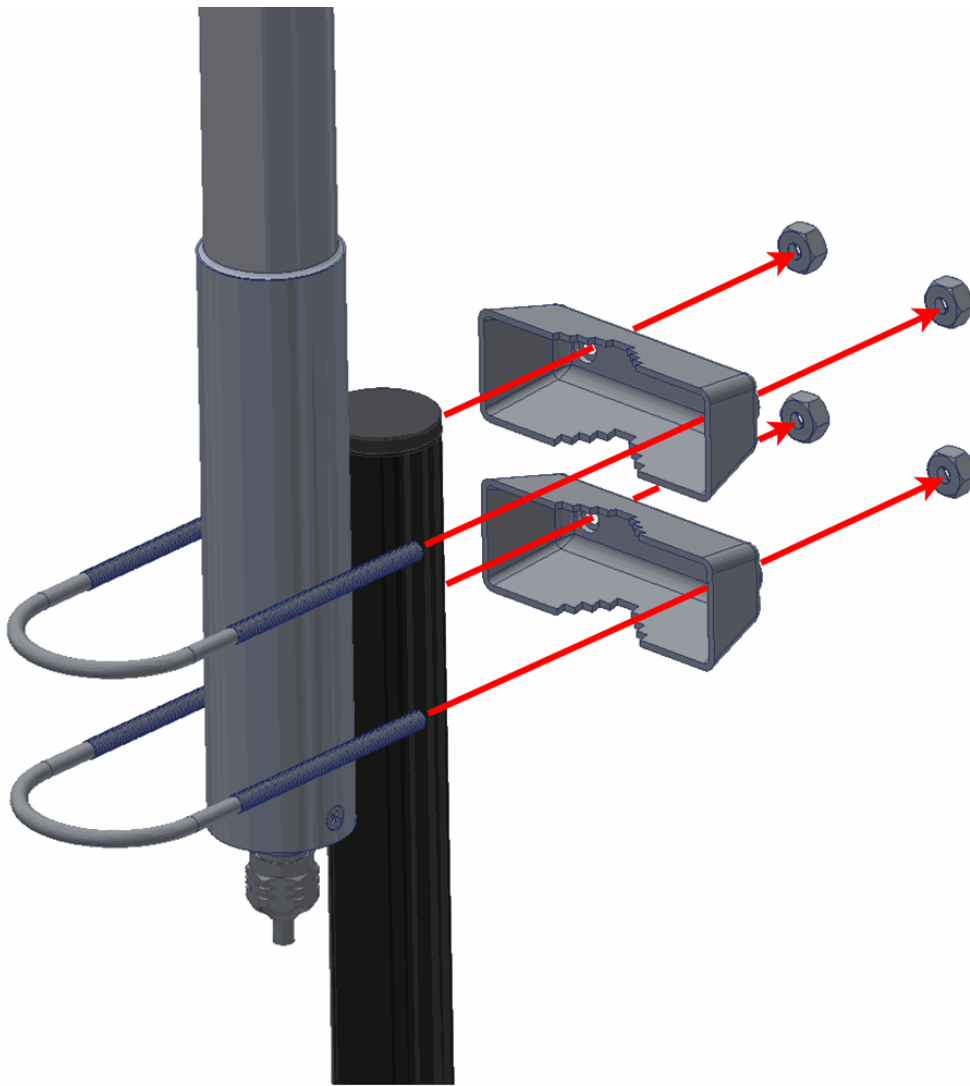

**MicroHard installation - Step 10**

11. Connect both antennas.

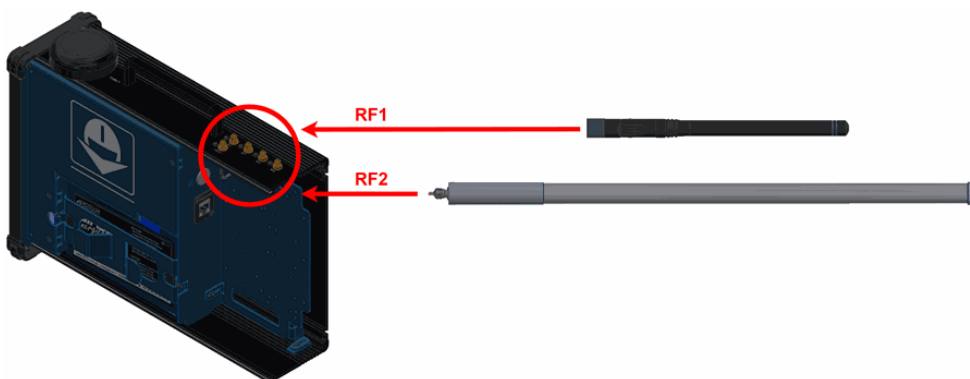

**MicroHard installation - Step 11  
(Diagram not scaled)**

- 12. Configure the **Veronte Autopilot 1x** as explained in [External radios - Integration examples](#) section of the **1x PDI Builder** user manual.
- 13. Connect the computer to the right ethernet port of the modem.

**⚠ Warning**

Do not connect the computer to the left port, since it is POE.

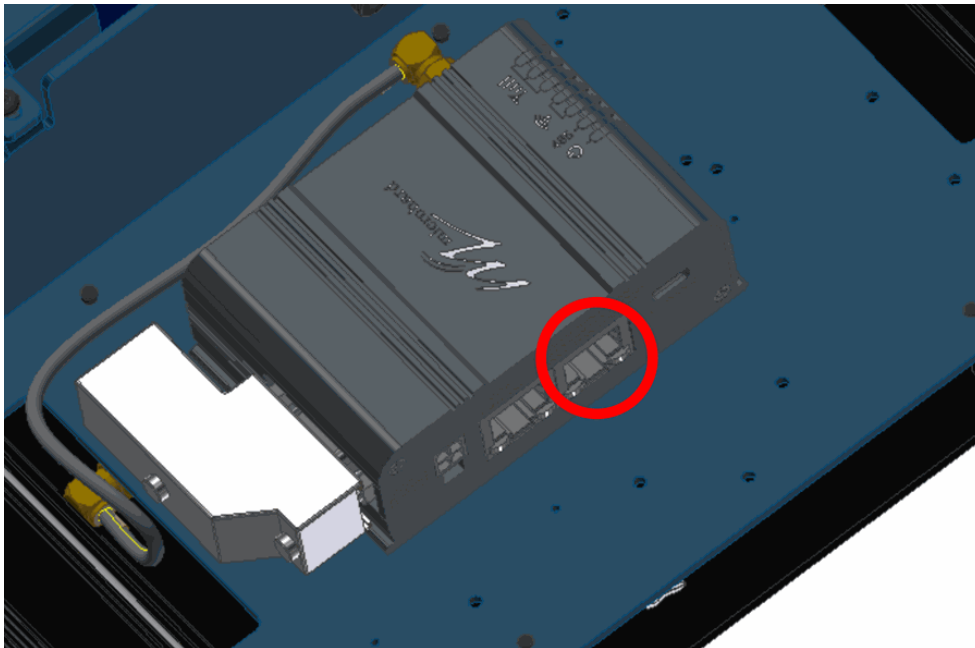
**MicroHard installation - Step 13**

14. To configure the modem, open a browser and introduce the following address on the search bar: 192.168.8.4.
15. Calibrate the modem to the desired power.
16. Once the modem and the autopilot have been configured, close the **PCS**.

## Datalink Kit J/K - Amplified Veronte SDL Modem

1. First of all, to access the expansion bay, read [Expansion Bay Access - Hardware Installation](#) section of this manual.
2. Screw the modem to the plate with four mushroom bolts M3 x 4.

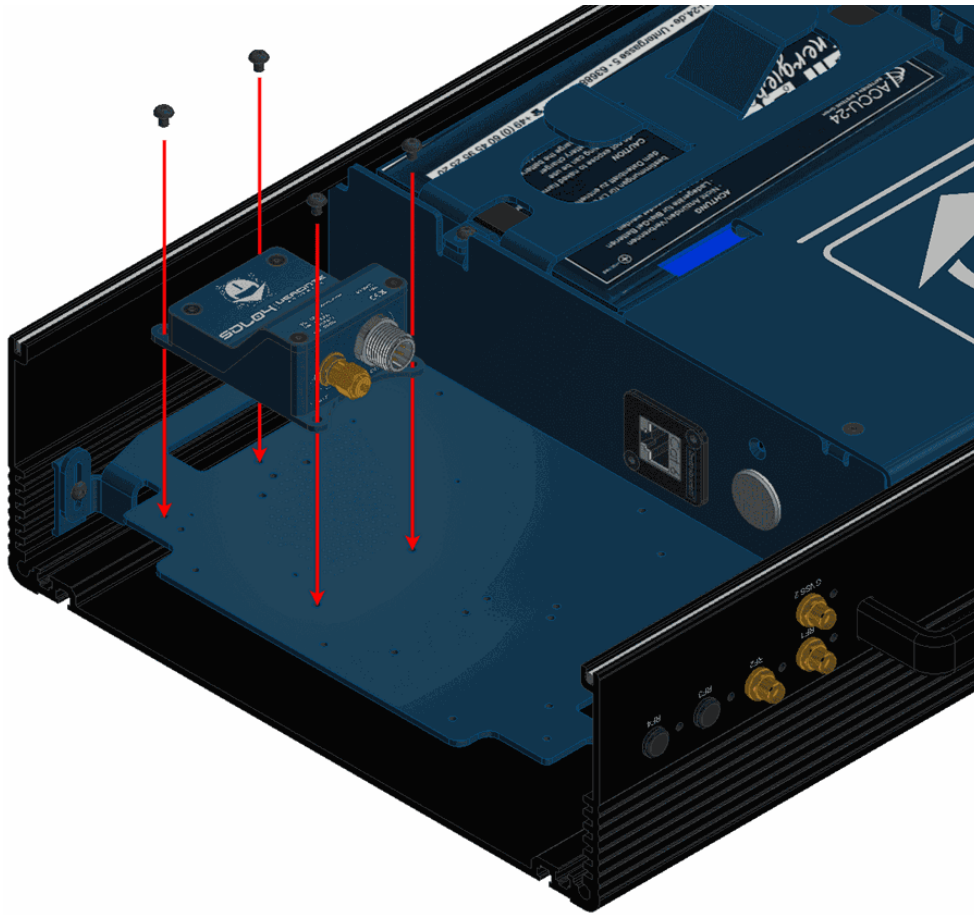

**Hardware amplified SDL installation - Step 2**

3. On the opposite side of the bay; screw the amplifier with three countersunk screws M3 x 30 and apply the thermal pad.

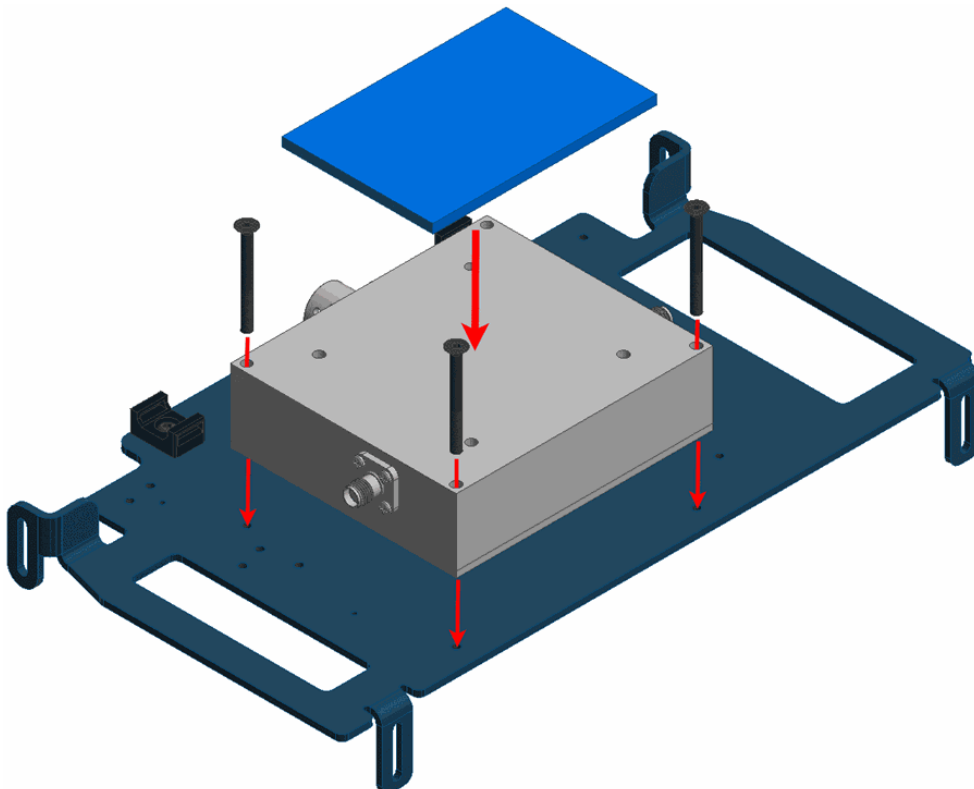

### Hardware amplified SDL installation - Step 3

4. Connect the modem and the amplifier as indicated by the following figure. Notice that the cable is passed through the plate hole.

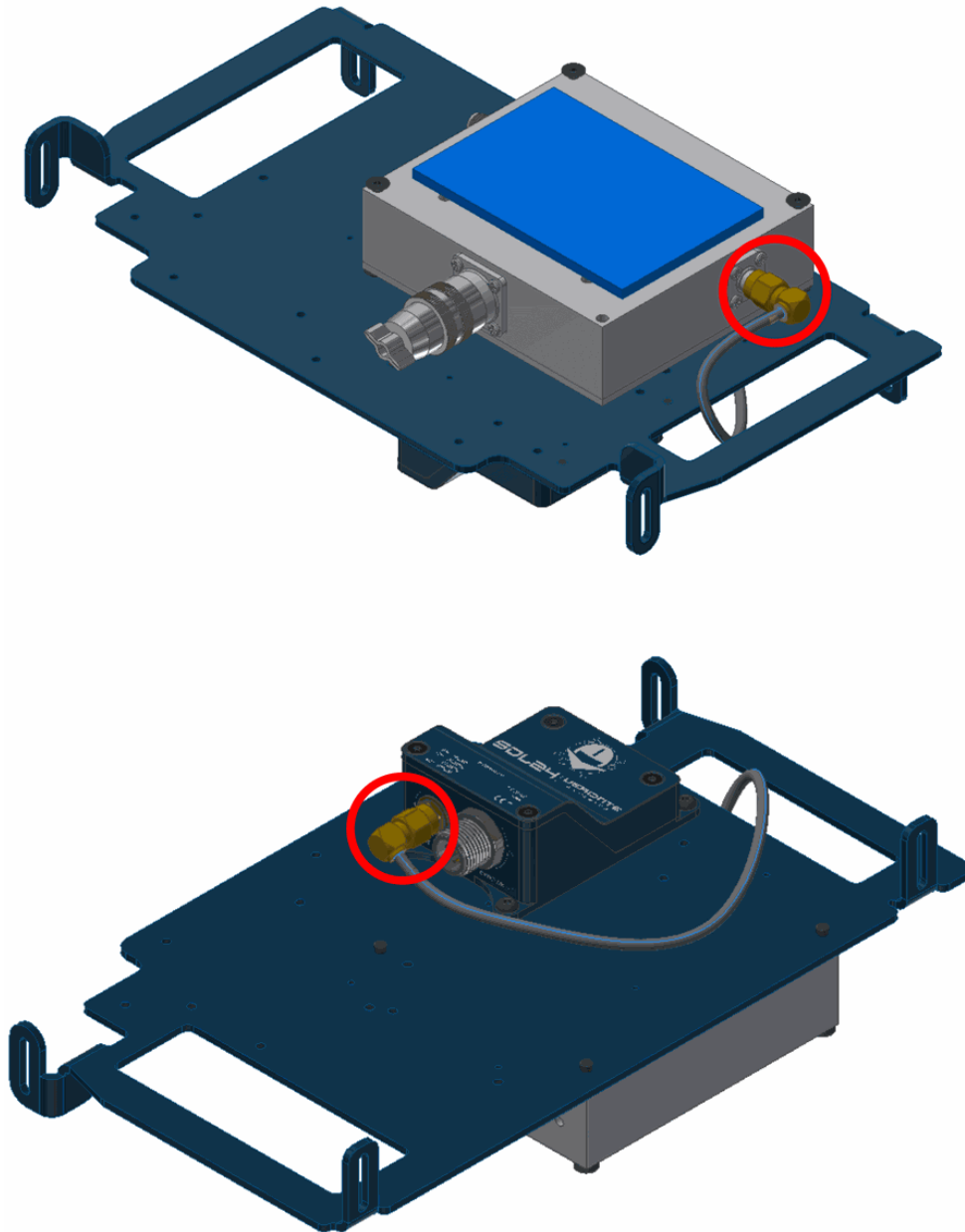

### Hardware amplified SDL installation - Step 4

5. Connect the amplifier to the **RF2** port. Again, the cable must be passed through the indicated hole.

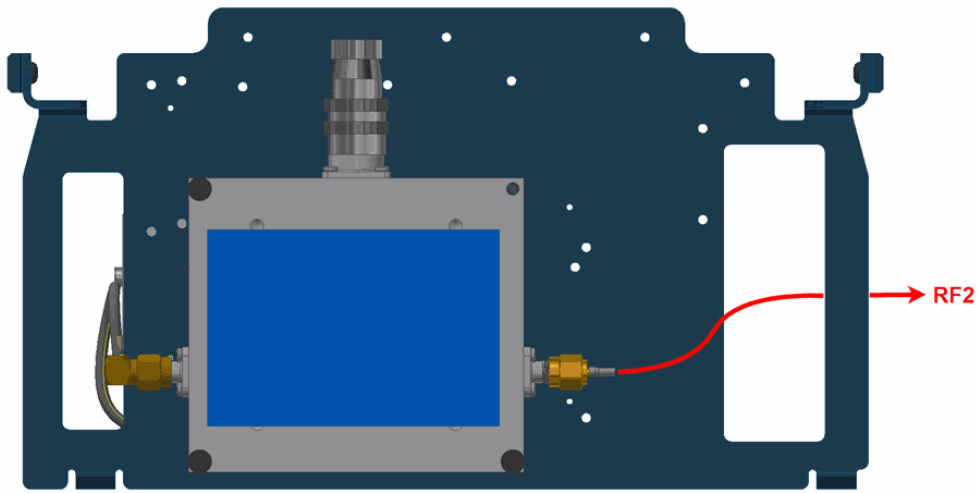

**Hardware amplified SDL installation - Step 5**

6. Place and screw the bay plate as the following image:

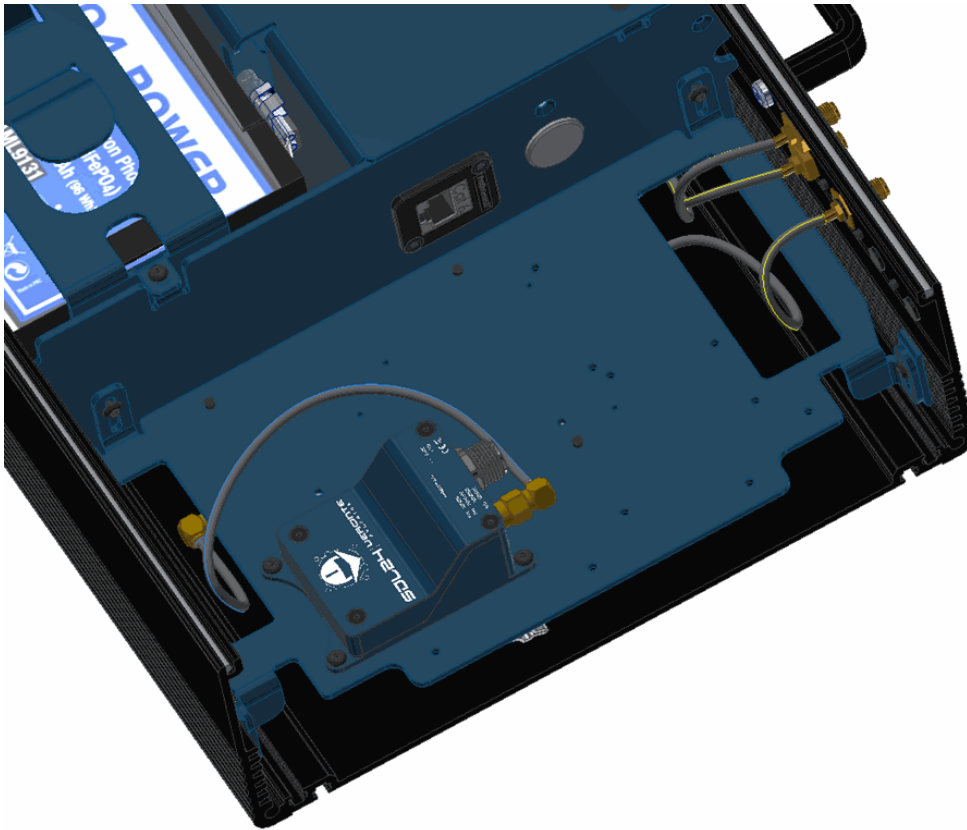

**Hardware amplified SDL installation - Step 6**

7. Connect the modem to the expansion connector.

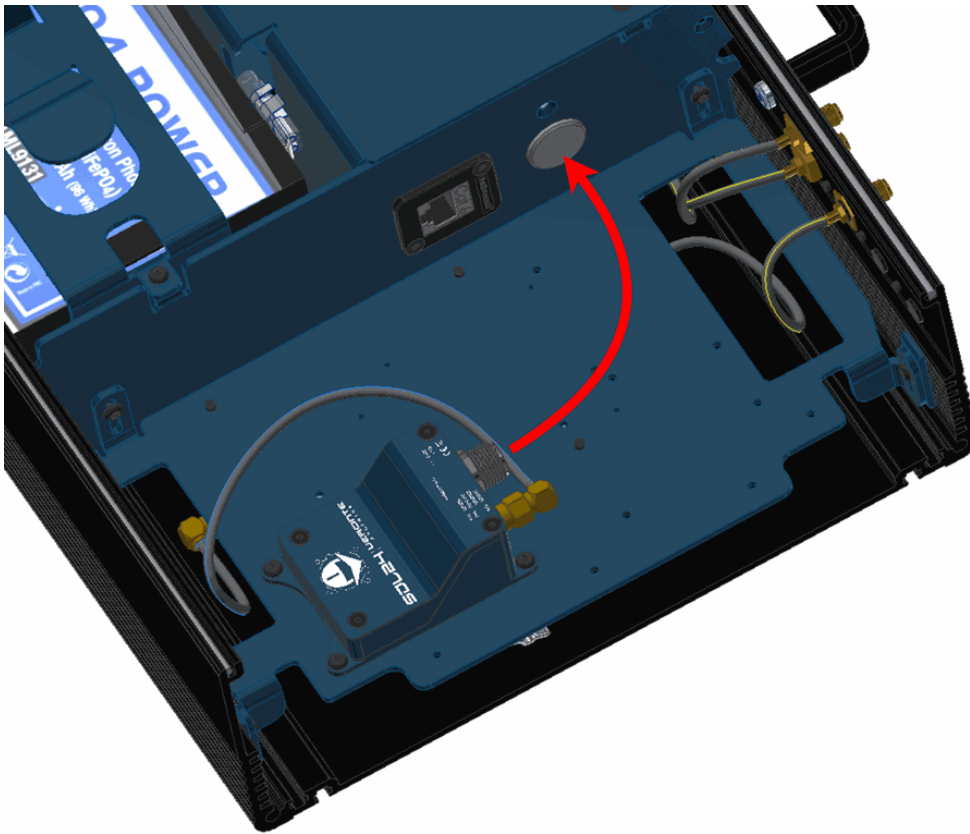

### Hardware amplified SDL installation - Step 7

8. Mount the **PCS** to the pole according to [Pole Mount Installation - Hardware Installation](#) section of this manual (do not close the expansion bay yet).
9. Attach the omnidirectional antenna to the pole mount.

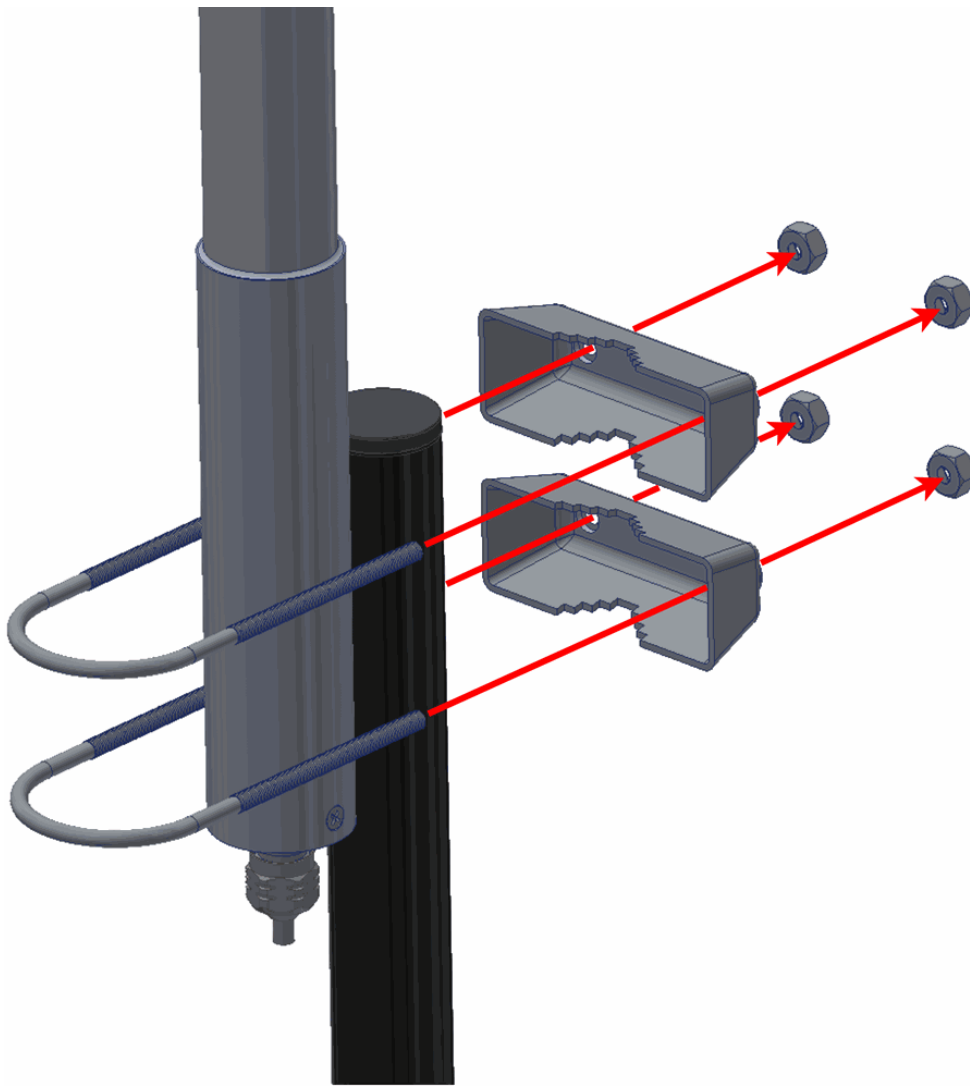

**Hardware amplified SDL installation - Step 9**

10. Connect both antennas.

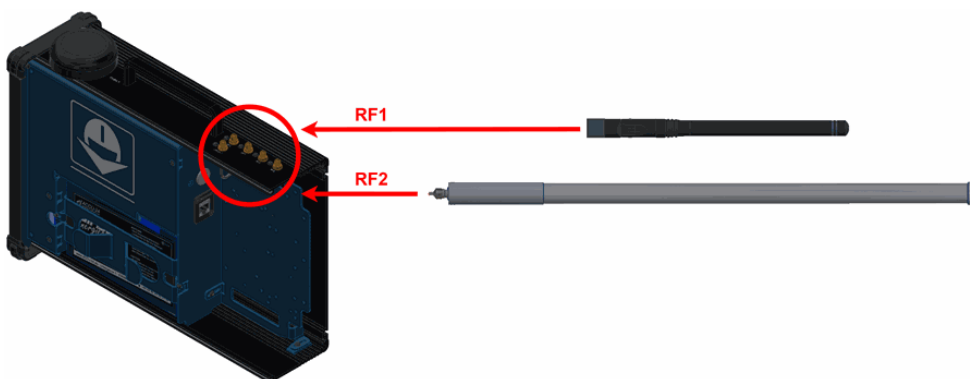

**Hardware amplified SDL installation - Step 10  
(Diagram not scaled)**

11. Configure the **Veronte Autopilot 1x** as explained in [External radios - Integration examples](#) section of **1x PDI Builder** user manual.

12. Configure the **Veronte Autopilot 1x** to communicate with **SDL** through a tunnel, to do it read [Tunnel - Input/Output](#) section of **1x PDI Builder** user manual.
13. Once the tunnel communication is established through **Autopilot 1x**, the modem can be configured with AT commands.
  - 13.1. First of all, to understand the basics, read [How to configure SDL - Software Installation](#) section of **SDL User Manual**.
  - 13.2. After that, read [Veronte Autopilot 1x - Integration Examples](#) section of **SDL User Manual**, to configure the **SDL**.
14. Once the **SDL** and the **Autopilot 1x** have been configured, close the **PCS**.

# Troubleshooting

## Maintenance mode

**Veronte Autopilot 1x** can enter in maintenance mode to solve issues of configuration. To know more about this mode, read [Maintenance mode - Troubleshooting](#) section of **1x Hardware Manual**.

**PCS** harness includes a maintenance button to force the maintenance mode, which connects both I2C pins. To use the maintenance button read the following steps:

1. Turn off the **PCS**.
2. Press and hold the maintenance button.
3. Turn on the **PCS** (do not release the maintenance button yet).
4. Release the button.

## Connection not established

### Wifi or ethernet not connecting

If the connection is not detected, follow the next instructions:

1. Open cmd and text ipconfig. Check that IPv4 Address is 192.168.8.95 for DTC or 192.168.8.4 for MH. Now there exists 2 options: if the IP is ok, ensure to make a total charge of the battery. If the IP is not the same:
  - The IP can be reserved for another device which has been connected recently. Wait for 2 minutes to free the IP (disconnect any other device from the PCS that could be interfering).
  - If there has not been any other device connected recently, the problem might be related to the adapter, which means a static IP has to be configured. To do that, go to Change Wi-Fi/Ethernet Settings – Change Adapter options and go to Properties in the desired network (in the following picture it is done for Wi-Fi network).

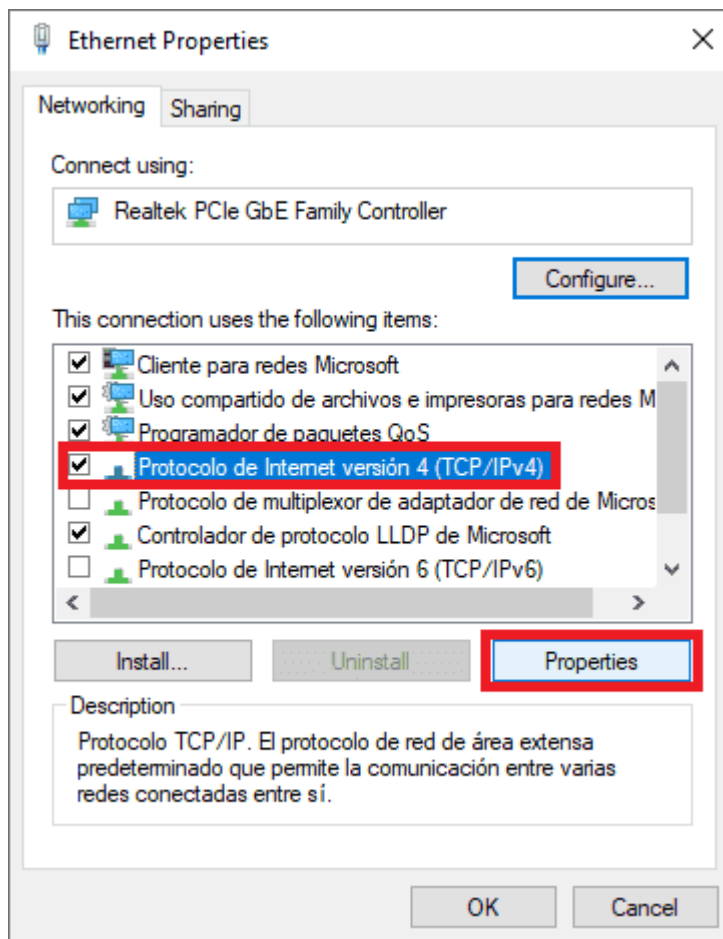

### How to operate - Wi-Fi/Ethernet Settings

- Once in Properties, check Protocol IPv4 and again Properties. There, configure the Static IP.

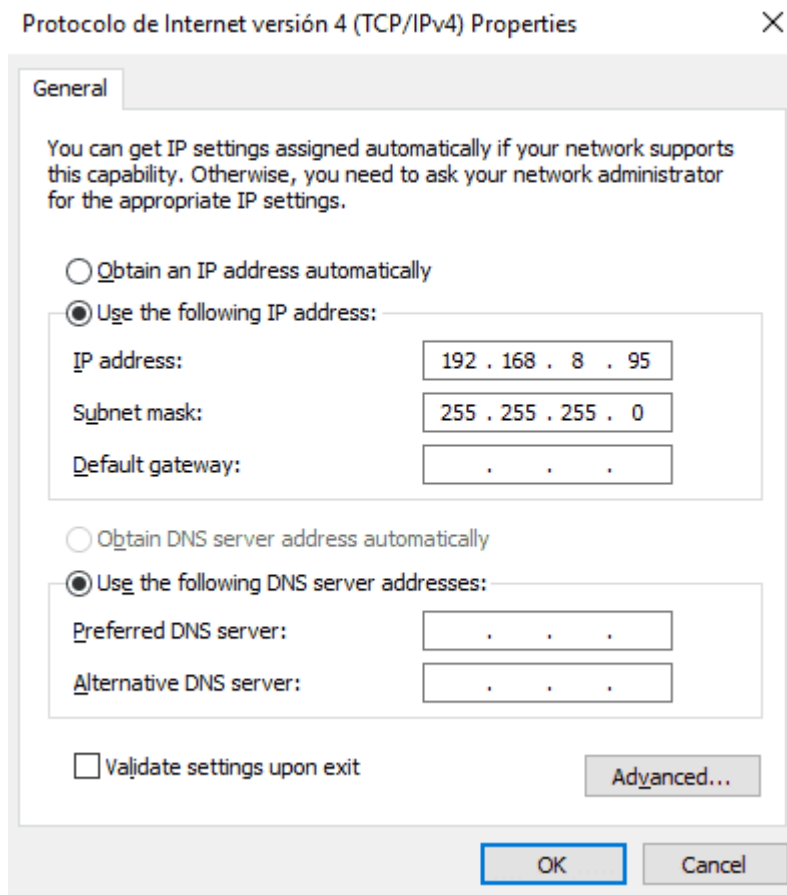

**Static IP Configuration example**

2. If after all these steps it cannot be configured, send an email to [support@embention.com](mailto:support@embention.com).

# Acronyms and Definitions

AC	Alternate Current
ARB	ARBiter signal
CAN	Controller Area Network
DHCP	Dynamic Host Configuration Protocol
DTC	DomoTaCtical company
EQEP	Enhanced Quadrature Encoder Pulse sensor
FTS	Fly Termination System signal
GND	Electrical Ground
GNSS	Global Navigation Satellite System
I2C	Inter-Integrated Circuit bus
LOS	Line of Sight
MCS	Multimedia Control Station
MH	MicroHard company
NC	No Connect
PCS	Pole Control Station
POE	Power Over Ethernet

---

PWM	Pulse Width Modulation signal
RF	Radio Frequency
RS-232	Recommended Standard 232
RS-485	Recommended Standard 485
RTK	Real Time Kinematic
SBUS	Serial BUS
SDL	Standard Data Link
TC	TeleCommunications
TM	Telemetry
VCC	Voltage Continuous Current

## Contact Data

For support-related inquiries, customers have access to a dedicated portal through the [Joint Collaboration Framework](#). This platform facilitates communication and ensures traceability of all support requests, helping us to address your needs efficiently.

For other questions or general inquiries, you can reach us via email at [sales@embention.com](mailto:sales@embention.com) or by phone at (+34) 965 115 421